

CENTRAL FLORIDA EXPRESSWAY AUTHORITY

MEMORANDUM

TO: Authority Board Members

FROM: Claude Miller 
Director of Procurement

DATE: August 25, 2015

RE: Relocation of Overhead Transmission Lines
S.R. 429 Systems Interchange
Project No. 429-204; Contract No. 001123

Board approval is requested to reimburse Duke Energy for the cost to relocate overhead transmission lines on Plymouth Sorrento Road. The current locations of the lines are in conflict with the construction of the referenced project.

Payment will be based on the actual cost invoiced by Duke Energy which should not exceed \$1,645,851.97. The estimate has been reviewed by our Wekiva Parkway Corridor Consultant who has determined that the amount is reasonable for the work to be performed.

Wekiva Parkway 429-204 (2B) Duke Energy - Transmission Relocation Cost Review

PREPARED FOR: Glenn Pressimone
Directory of Engineering

PREPARED BY: Scott Bear *SWB*

DATE: August 24, 2015

CH2M HILL was provided the Utility Estimate Summary for the costs associated with Duke Energy – Transmission's temporary facility relocations associated with the above referenced section of Wekiva Parkway. In addition to the Utility Estimate Summary, Duke submitted their red/green/brown Utility Relocation plans reflecting the changes proposed in the Utility Estimate Summary.

Our staff utilized these two pieces of information and the proposed construction plans prepared by Atkins North America for Wekiva Parkway to review the anticipated relocation costs for reasonableness and consistency with industry standards. Further, our staff compared the 429-204 Utility Estimate Summary to the 429-202 Utility Estimate Summary for comparison of costs and anticipated expenses.

The Duke Energy Transmission package was fairly straight forward based upon the preliminary Utility Relocation Plans submitted. It is important to note these plans are not final construction plans, but demonstrate the intent Duke has for their temporary and permanent facilities.

After review of the Transmission package, the estimate appears to be reasonable for the work anticipated. As with the 429-202 Utility Estimate Summary, the 429-204 package provided by Duke Energy Transmission staff did not include their proprietary detailed cost information, so our determination is based upon utilizing generally accepted practices and ranges for similar projects CH2M HILL has designed elsewhere in the country for other electric utility agencies as well as those provided by Duke Energy on the previous Wekiva Parkway section.

Copies of the cost estimates, relocation plans, red/green/brown plans and relocation schedules for both Transmission and Distribution are attached as reference to this memorandum.

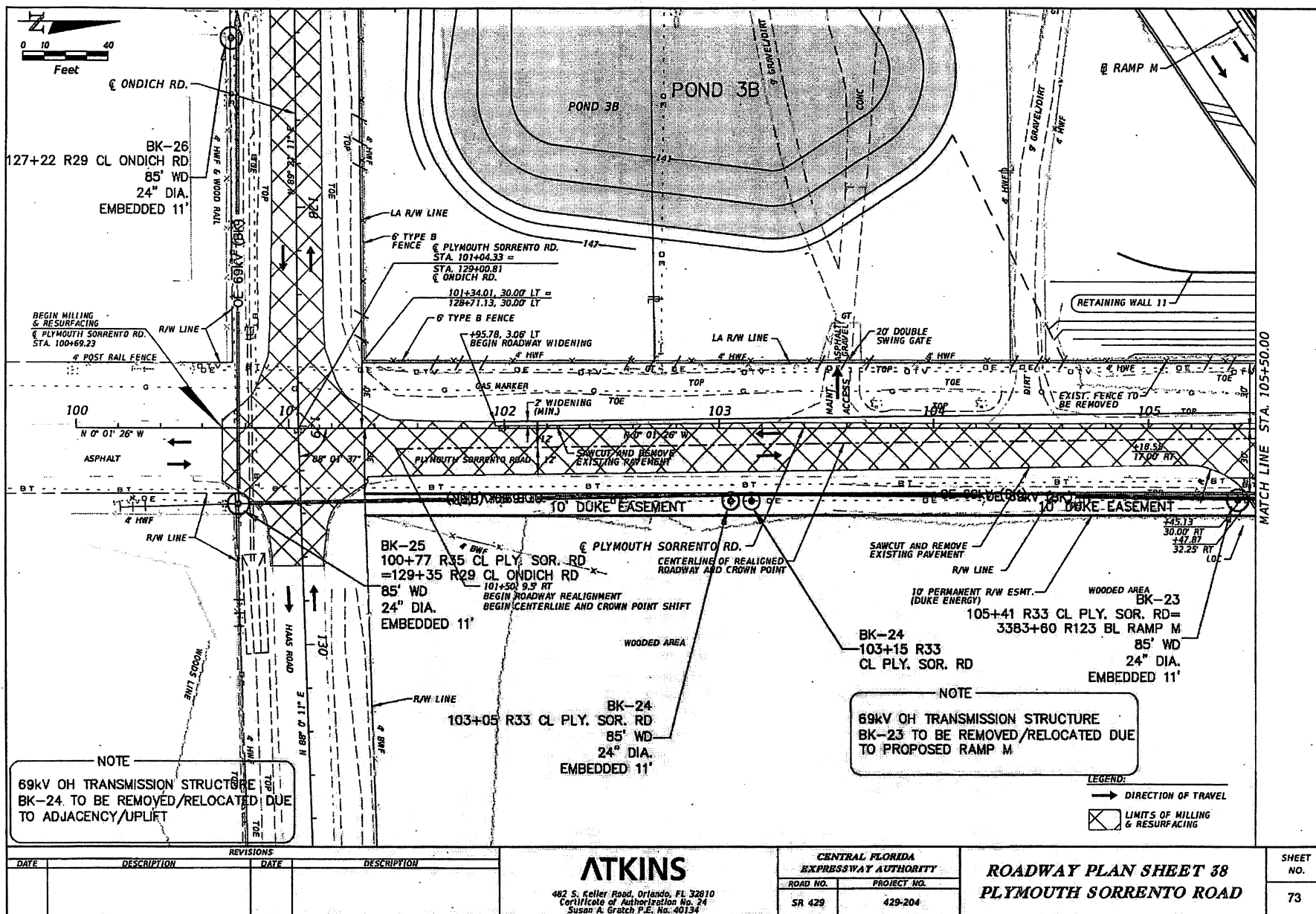

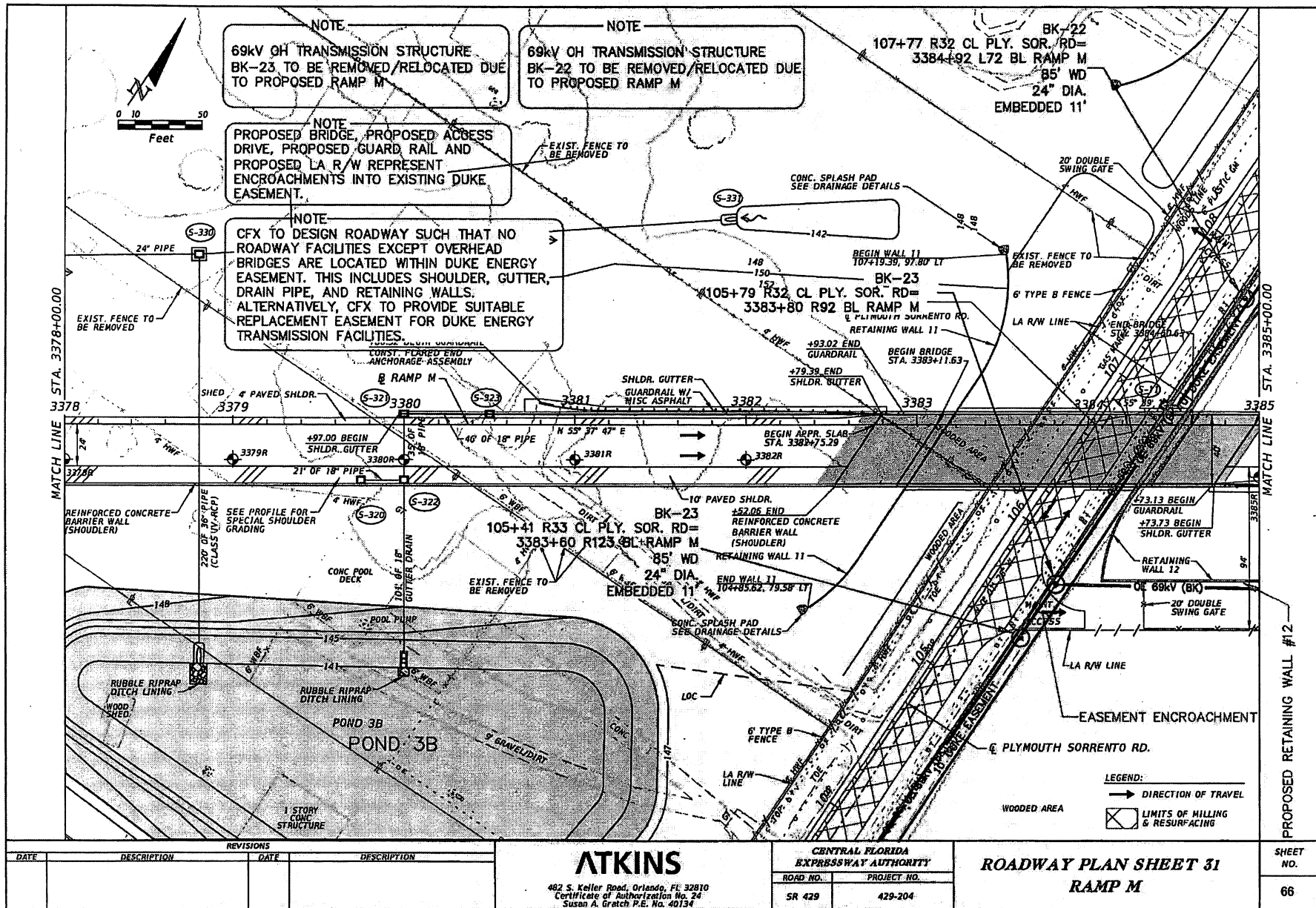

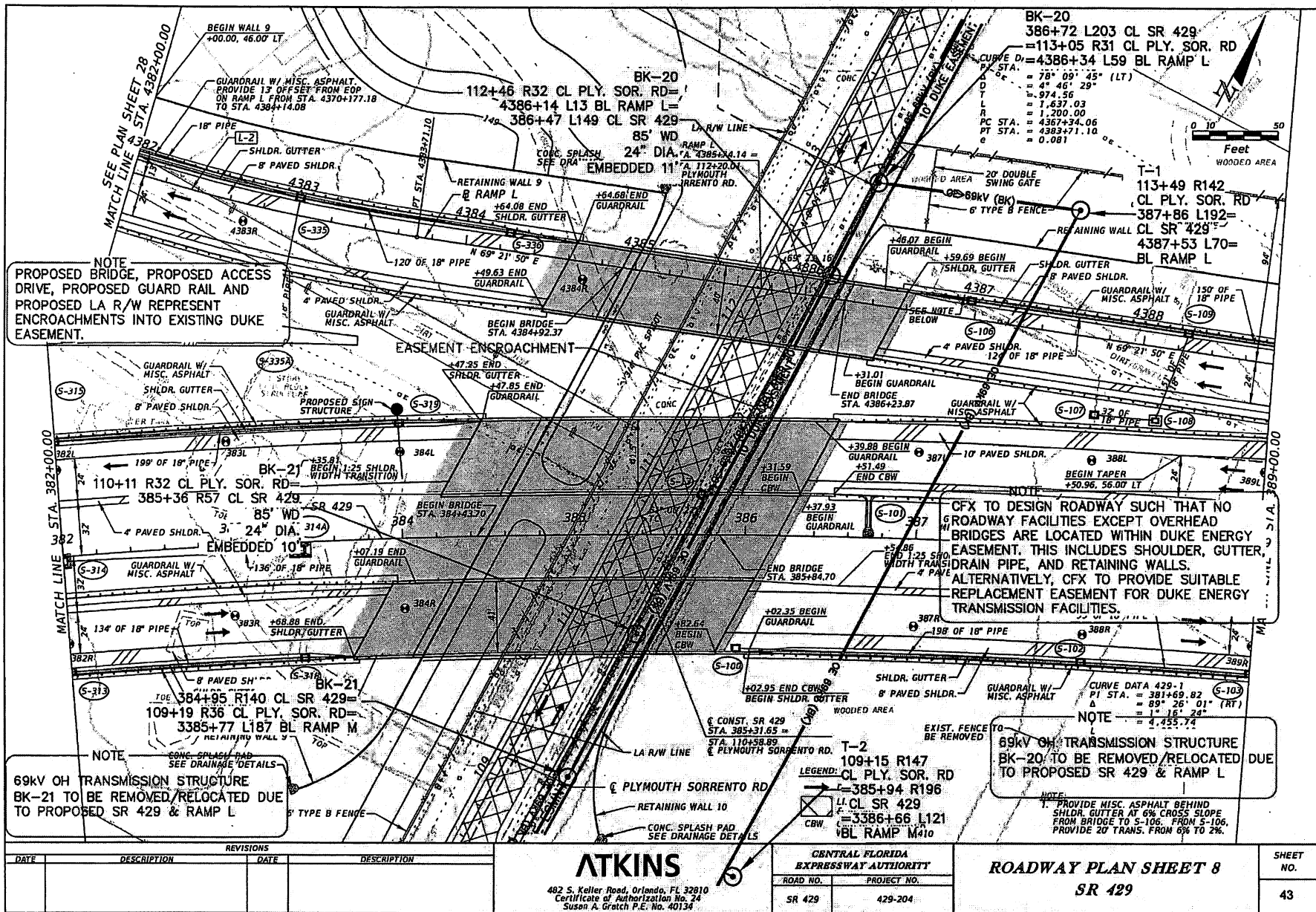

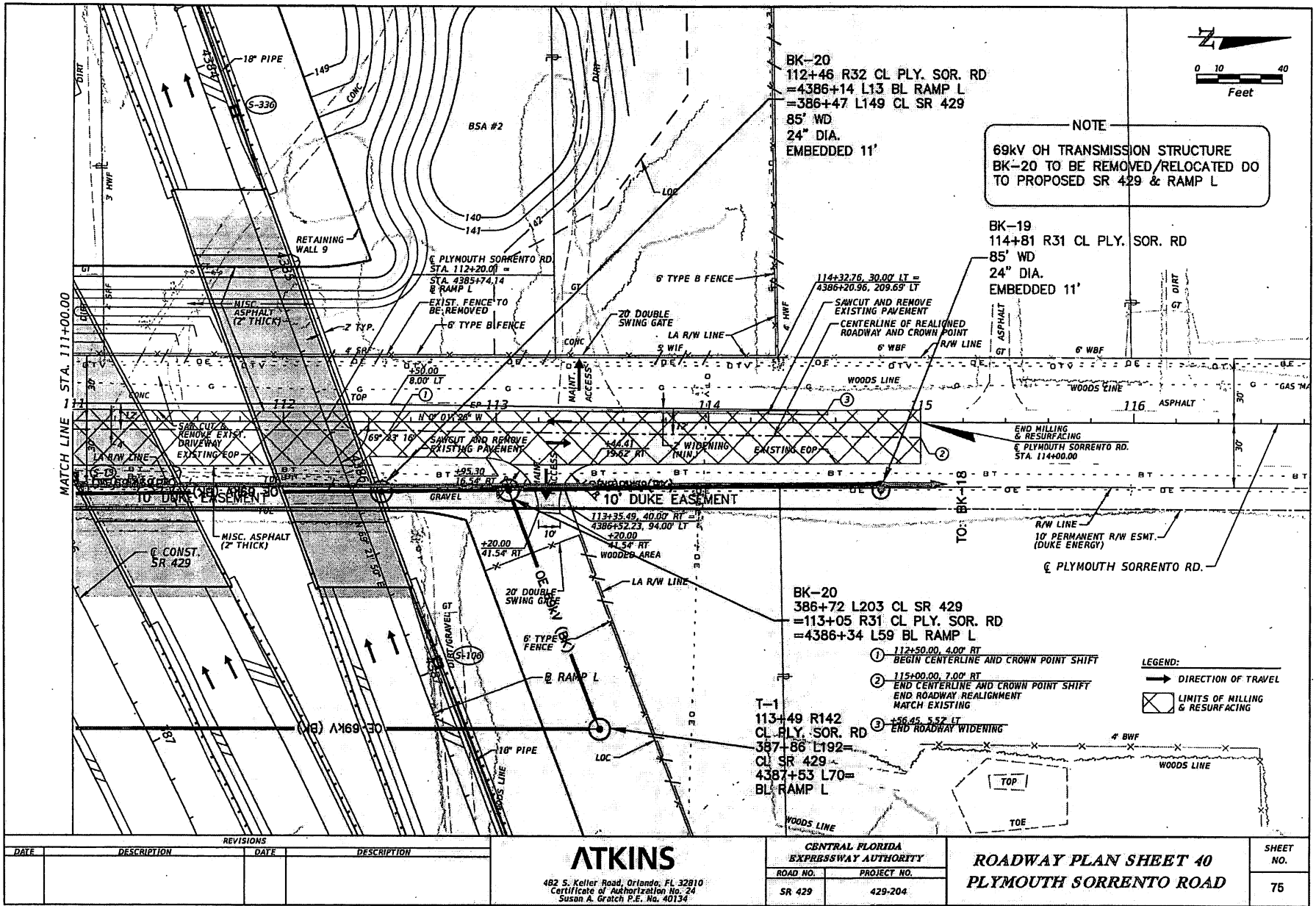

2451T2 - BK 69kV Wekiva Pkwy OOCEA
431081-1-32-01 Orange Co
UTILITY ESTIMATE SUMMARY

Financial Management No.: 431081-1-32-01	Federal Aid No.: 431081-1-32-01
County: Orange	State Road No.: 2451T2 - BK 69kV Wekiva Pkwy_OOCEA 431081-1-32-01 Orange Co
Utility Agency/Owner(UAO): DUKE ENERGY FLORIDA, D/B/A DUKE ENERGY-TRANSMISSION	

TYPE OF WORK ESTIMATED: (Mark "X" in appropriate box(es).)

<u>Engineering</u>	<u>Relocation/ Installation</u>	<u>Items(s)</u>
<input checked="" type="checkbox"/>	<input checked="" type="checkbox"/>	Force Account
<input type="checkbox"/>	<input type="checkbox"/>	Lump Sum
<input type="checkbox"/>	<input type="checkbox"/>	Third Party Contract
<input type="checkbox"/>	<input type="checkbox"/>	Other _____

Estimate Summary: (If more than one work order complete "Total" column)

RW (Acquisition Only)			
Construction Engineering			\$ 288,934.10
Construction Labor			\$ 706,740.89
Materials & Supplies			\$ 534,593.80
Materials Handling Charges			\$ -
Transportation & Equipment			\$ -
Contract Construction			\$ -
Miscellaneous Expense			\$ -
Inspection Costs			\$ -
General Overhead Costs (15%)			\$ 115,583.18
GROSS RELOCATION COSTS:			\$ -
*Salvage			\$ -
*Betterment			\$ -
*Expired Service Life			\$ -
*Nonreimbursable			\$ -
TOTAL CREDITS:	()	()	()
TOTAL REIMBURSABLE COSTS:			\$ 1,645,851.97
*% To be Applied to Final Billing for Credits Due Project.	(%)	(%)	(%)

Submitted for the utility owner by:

Joel Chatham

August 6, 2015

Print Name

Date

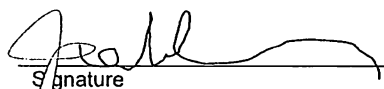
 Signature

CENTRAL FLORIDA EXPRESSWAY AUTHORITY
UTILITY WORK SCHEDULE

UTILITIES
8/11/2015
1 of 7

Project Title: Wekiva Parkway - Segment 2B		County Road Number: N/A	
State Road No: 429		City Road: N/A	
		Project No: 429-204	
UTILITY AGENCY/OWNER (UAO): Duke Energy Transmission			
A. Summary of Utility Work and Execution			

<u>NON-CONSTRUCTION ITEMS</u>	<u>ESTIMATED CALENDAR DAYS</u>	<u>CONSTRUCTION ITEMS</u>	<u>ESTIMATED CALENDAR DAYS</u>
Preliminary	90	Prior to CFX Project Construction	
Material Procurement	210	During CFX Project Construction	78
Right-of-way Acquisition	0	Total	78
Other	65		
Total	365		

This document has been developed as a method for a Utility Agency/Owner (UAO) to transmit to the Central Florida Expressway Authority (CFX), the Highway Contractor, and other right-of-way users, the location, relocation, adjustment, installation, and/or protection of their facilities, on this CFX project. The following data is based on CFX preliminary construction plans dated March 2015. Any deviation by the CFX or its contractor from the plans, as provided, may render this work schedule null and void. Upon notification by the CFX of such change, this utility may require additional days for assessment and negotiation of a new work schedule. This UAO is not responsible for events beyond the control of the UAO that could not reasonably be anticipated by the UAO and which could not be avoided by the UAO with the exercise of due diligence at the time of the occurrence. The UAO agrees to notify the CFX in writing prior to starting, stopping, resuming, or completing work.

During the project, the UAO shall locate their facilities within 48 hours of notice to their

Representative: Joel Chatham Telephone Number: 407-942-9640

This UAO's Field Representative: George Baxter Telephone Number: 727-483-3242

This document is a printout of an CFX form maintained in an electronic format and all revisions thereto by the UAO in the form of additions, deletions, or substitutions are reflected only in an Appendix entitled "Changes to Form Document" and no change is made in the text of the document itself. Hand notations on affected portions of this document may refer to changed reflected in the above-named Appendix but are for reference purposes only and do not change the terms of the document. By signing this document, the UAO hereby represents that no change has been made to the text of this document except through the terms of the appendix entitled "Changes to Form Document."

x ☐ No changes to forms document.

☐ Appendix "Changes to Forms Document" is attached. _____ Number of Attachment Pages.

<p>Authorized Utility Agent:</p> <div style="display: flex; justify-content: space-between; align-items: flex-start;"> <div style="text-align: center;"> (Signature) <u>Ed Burkot</u> (Printed Name) <u>Senior Engineer</u> (Title) </div> <div style="text-align: center;"> <u>8-11-2015</u> (Date) </div> </div>	<p>Acceptance by CFX:</p> <div style="display: flex; justify-content: space-between; align-items: flex-start;"> <div style="text-align: center;"> (Signature) <u>Joseph Berenils, P.E.</u> (Printed Name) <u>Deputy Executive Director</u> (Title) </div> <div style="text-align: center;"> <u>8/14/15</u> (Date) </div> </div>
--	---

CENTRAL FLORIDA EXPRESSWAY AUTHORITY
UTILITY WORK SCHEDULE

UTILITIES
8/11/2015
2 of 7

Project Title: Wekiva Parkway - Segment 2B	County Road Number: N/A
State Road No: 429	City Road: N/A
Project No: 429-204	
UTILITY AGENCY/OWNER (UAO): Duke Energy Transmission	
B.	Special Conditions / Constraints
<p>1) The Duke Energy Transmission (DET) existing facilities indicated on the attached plans are shown as they existed on 02/2012, in reference to the drawings dated 3/2015. Please contact the DET UAO representative previously listed to ensure that changes have not taken place and if so, what those changes are prior to performing any work that may be dependent upon the DET facilities' location and related data.</p> <p>2) When requesting outages, the contractor must follow these guidelines:</p> <p>i. The roadway contractor must provide an outage package indicating: the scope of work, start to finish schedule, type of equipment utilized, contractor team contact information, design drawings and other information as identified by DET as necessary. Outage initiation requires a minimum of 21-days from the approval of the outage package.</p> <p>In cases where multiple transmission lines are impacted by the project, DET will only allow one circuit out of service at any given time.</p> <p>ii. If at any time a de-energized line will need to be placed back into service, such as a system emergency (e.g. hurricane, loss of another transmission line, and/or extreme load, etc.) DET will ask the roadway contractor, within a two hour period, to shut down any construction that would restrict DET construction crews from placing the de-energized line back into service.</p> <p>iii. Typically, any de-energizing of any DET lines can only occur during the following time periods: October 1st to November 15th, and March 1st to April 15th. Any additional required de-energized time periods needed throughout the project will need to be coordinated with the UAO representative previously listed.</p> <p>iv. Typically an outage cannot exceed a two-week duration; a new request may be required if additional outage time is needed.</p> <p>v. DET can NOT guarantee that the roadway contractor will get the approval for the outage; it is the contractor's responsibility to follow up with the above-listed contact.</p> <p>vi. If for any reason the outage was approved but can't be accomplished, then DET will reserve the right to cancel the outage with 2-hours advance notification</p> <p>vii. In cases where multiple transmission lines are impacted by the project, DET will only allow one circuit out of service at any given time.</p> <p>viii. A responsible representative from the roadway contractor's staff will attend all daily and necessary pre-job briefing meetings conducted by DET.</p> <p>3) This project is to be constructed in the vicinity of energized 69kV OH transmission.</p> <p>4) When doing any work or task under or near any DET facilities, all NESC & OSHA guidelines must be adhered to.</p> <p>5) Any relocation of existing or proposed DET facilities beyond what is described in this document that is required to accommodate construction will require notice sufficient to cover analysis, design, material logistics & mobilization/demobilization.</p> <p>6) When the roadway contractor is excavating around DET facilities, they shall provide at least a 15-foot horizontal clearance to the facility; if this cannot be met, a notification must be sent to the UAO Field Representative previously listed to arrange for a field meeting.</p> <p>7) No grading is allowed within any DET easement without prior approval from Asset Protection</p> <p>8) The DET Project Representative shall be notified by the CFX or roadway contractor when any dependent activities are completed.</p> <p>9) All relocation activities by DET will be performed during regular working hours. No night time activities will be performed unless otherwise coordinated in advance.</p> <p>10) DET & DET contractor crews availability may be affected or limited due to DET requirement to respond to emergency conditions on or off of the DET system. This emergency response condition may affect this project's construction schedule</p> <p>11) Removal of DET facilities is contingent upon all joint users vacating DET's structures.</p> <p>12) Proposed light poles 414 & 211 are not to be installed until after the temporary transmission circuit is removed</p>	

CENTRAL FLORIDA EXPRESSWAY AUTHORITY
UTILITY WORK SCHEDULE

UTILITIES
8/11/2015
3 of 7

Project Title: Wekiva Parkway - Segment 2B	County Road Number: N/A
State Road No: 429	City Road: N/A
	Project No: 429-204
UTILITY AGENCY/OWNER (UAO): Duke Energy Transmission	
B.	Special Conditions / Constraints

Conditions continued...

13) Upon completion of adjustment of this utility's facilities as described in this approved Utility Work Schedule-any additional adjustment of this Utility's same facilities that is required due to deviation by the CFX or its roadway contractor from the above referenced roadway plan date provided to this utility will be conveyed to the CFX and/or its roadway contractor for consideration to mitigate the conflict or for review by the CFX for reimbursement. Upon agreement with the CFX, this Utility will proceed with the design and construction of the additional adjustment within the standard work schedule of this utility.

14) Clearing & grubbing is to be performed by CFX or its contractor prior to DET beginning its construction.

15) Temporary box outs to be removed approximately 18 months after start of roadway construction. CFX to provide a minimum of 4 months advance notice prior to DET crew removing box outs.

16) The estimated calendar days of construction assumes all work is done during normal business, daylight hours, that there are no weather related work delays, and that no emergency situations arise to cause the crew to stop work on this project.

CENTRAL FLORIDA EXPRESSWAY AUTHORITY
UTILITY WORK SCHEDULE

UTILITIES
8/11/2015
4 of 7

Project Title: Wekiva Parkway - Segment 2B		County Road Number: N/A		
State Road No: 429		City Road: N/A		
		Project No: 429-204		
UTILITY AGENCY/OWNER (UAO): Duke Energy Transmission				
C.	Disposition of Facilities (List All Existing & Proposed) on Project:			
UTILITY FACILITIES by TYPE/SIZE/MATERIAL/OFFSET TO BASELINE FROM STA TO STA	DESCRIPTION OF UTILITY WORK	DEPENDENT ACTIVITIES	M.O.T. Phase Number	CONSECUTIVE CALENDAR DAYS
CONSTRUCTION DURING CFX CONSTRUCTION				
CL Ondich Rd				
108+84 R27; BK-34; 85' WD; 24" DIA.; EMBEDDED 11'	OH TRANSMISSION STRUCTURE TO BE REMOVED	Special condition numbers 8 & 11	Prior to construction	2
109+29 R27; BK-34	PROPOSED OH TRANSMISSION STRUCTURE	Special condition numbers 8 & 14	Prior to construction	3
109+29 R120; T-6	PROPOSED TEMPORARY OH TRANSMISSION STRUCTURE	Special condition numbers 8 & 14	Prior to construction	3
111+08 R28; BK-33; 85' WD; 24" DIA.; EMBEDDED 11'	OH TRANSMISSION STRUCTURE TO BE REMOVED	Special condition numbers 8 & 11	Prior to construction	2
113+32 R28; BK-32; 85' WD; 24" DIA.; EMBEDDED 12'	OH TRANSMISSION STRUCTURE TO BE REMOVED	Special condition numbers 8 & 11	Prior to construction	2
114+40 R125; T-5	PROPOSED TEMPORARY OH TRANSMISSION STRUCTURE	Special condition numbers 8 & 14	Prior to construction	3
115+16 R30; BK-30	PROPOSED OH TRANSMISSION STRUCTURE	Special condition numbers 8 & 14	Prior to construction	3
115+62 R28; BK-31; 85' WD; 24" DIA.; EMBEDDED 12'	OH TRANSMISSION STRUCTURE TO BE REMOVED	Special condition numbers 8 & 11	Prior to construction	2
117+85 R28; BK-30; 85' WD; 24" DIA.; EMBEDDED 12'	OH TRANSMISSION STRUCTURE TO BE REMOVED	Special condition numbers 8 & 11	Prior to construction	2
118+99 R141; T-4	PROPOSED TEMPORARY OH TRANSMISSION STRUCTURE	Special condition numbers 8 & 14	Prior to construction	3
119+61 R28; BK-29	PROPOSED OH TRANSMISSION STRUCTURE	Special condition numbers 8 & 14	Prior to construction	3

CENTRAL FLORIDA EXPRESSWAY AUTHORITY
UTILITY WORK SCHEDULE

UTILITIES
8/11/2015
5 of 7

Project Title: Wekiva Parkway - Segment 2B		County Road Number: N/A		
State Road No: 429		City Road: N/A		
		Project No: 429-204		
UTILITY AGENCY/OWNER (UAO): Duke Energy Transmission				
C.	Disposition of Facilities (List All Existing & Proposed) on Project:			
UTILITY FACILITIES by TYPE/SIZE/MATERIAL/OFFSET TO BASELINE FROM STA TO STA	DESCRIPTION OF UTILITY WORK	DEPENDENT ACTIVITIES	M.O.T. Phase Number	CONSECUTIVE CALENDAR DAYS
CONSTRUCTION DURING CFX CONSTRUCTION				
120+08 R28; BK-29; 85' WD; 24" DIA.; EMBEDDED 11'	OH TRANSMISSION STRUCTURE TO BE REMOVED	Special condition numbers 8 & 11	Prior to construction	2
122+32 R28; BK-28; 85' WD; 24" DIA.; EMBEDDED 11'	OH TRANSMISSION STRUCTURE TO BE REMOVED	Special condition numbers 8 & 11	Prior to construction	2
122+42 R28; BK-28	PROPOSED OH TRANSMISSION STRUCTURE	Special condition numbers 8 & 14	Prior to construction	3
124+77 R28; BK-27; 85' WD; 24" DIA.; EMBEDDED 11'	OH TRANSMISSION STRUCTURE TO REMAIN	NONE	NONE	0
127+22 R29; BK-28; 85' WD; 24" DIA.; EMBEDDED 11'	OH TRANSMISSION STRUCTURE TO REMAIN	NONE	NONE	0
129+00; BK-26 TO BK-25; 69kV;	OH TRANSMISSION CROSSING	NONE	NONE	0
129+35 R29; BK-25; 85' WD; 24" DIA.; EMBEDDED 11'	OH TRANSMISSION STRUCTURE TO REMAIN	NONE	NONE	0
CL Plymouth Sorrento Rd				
100+77; BK-26 TO BK-25; 69kV;	OH TRANSMISSION CROSSING	NONE	NONE	0
100+77 R35; BK-25; 85' WD; 24" DIA.; EMBEDDED 11'	OH TRANSMISSION STRUCTURE TO REMAIN	NONE	NONE	0
103+05 R33; BK-24; 85' WD; 24" DIA.; EMBEDDED 11'	OH TRANSMISSION STRUCTURE TO REMOVED	Special condition numbers 8 & 11	Prior to construction	2
103+15 R33; BK-24;	PROPOSED OH TRANSMISSION STRUCTURE	Special condition numbers 8 & 14	Prior to construction	3
105+41 R33; BK-23; 85' WD; 24" DIA.; EMBEDDED 11'	OH TRANSMISSION STRUCTURE TO BE REMOVED	Special condition numbers 8 & 11	Prior to construction	2

CENTRAL FLORIDA EXPRESSWAY AUTHORITY
UTILITY WORK SCHEDULE

UTILITIES
8/11/2015
6 of 7

Project Title: Wekiva Parkway - Segment 2B		County Road Number: N/A		
State Road No: 429		City Road: N/A		
		Project No: 429-204		
UTILITY AGENCY/OWNER (UAO): Duke Energy Transmission				
C.	Disposition of Facilities (List All Existing & Proposed) on Project:			
UTILITY FACILITIES by TYPE/SIZE/MATERIAL/OFFSET TO BASELINE FROM STA TO STA	DESCRIPTION OF UTILITY WORK	DEPENDENT ACTIVITIES	M.O.T. Phase Number	CONSECUTIVE CALENDAR DAYS
CONSTRUCTION DURING CFX CONSTRUCTION				
105+79 R32; BK-23;	PROPOSED OH TRANSMISSION STRUCTURE	Special condition numbers 8 & 14	Prior to construction	3
106+49 R143; T-3	PROPOSED TEMPORARY OH TRANSMISSION STRUCTURE	Special condition numbers 8 & 14	Prior to construction	3
107+77 R32; BK-22; 85' WD; 24" DIA.; EMBEDDED 11'	OH TRANSMISSION STRUCTURE TO BE REMOVED	Special condition numbers 8 & 11	Prior to construction	2
109+19 R36; BK-21	PROPOSED OH TRANSMISSION STRUCTURE	Special condition numbers 8 & 14	Prior to construction	3
109+15 R147; T-2	PROPOSED TEMPORARY OH TRANSMISSION STRUCTURE	Special condition numbers 8 & 14	Prior to construction	3
110+11 R32; BK-21 85' WD; 24" DIA.; EMBEDDED 10'	OH TRANSMISSION STRUCTURE TO BE REMOVED	Special condition numbers 8 & 11	Prior to construction	2
112+46 R32; BK-20; 85' WD; 24" DIA.; EMBEDDED 11'	OH TRANSMISSION STRUCTURE TO BE REMOVED	Special condition numbers 8 & 11	Prior to construction	2
113+05 R31; BK-20	PROPOSED OH TRANSMISSION STRUCTURE	Special conditions number 8 & 14	Prior to construction	3
113+49 R142; T-1	PROPOSED TEMPORARY OH TRANSMISSION STRUCTURE	Special condition number 8 & 14	Prior to construction	3
114+81 R31; BK-19; 85' WD; 24" DIA.; EMBEDDED 11'	OH TRANSMISSION STRUCTURE TO REMAIN	NONE	NONE	0
Temporary Box Out Removal				
109+29 R120; T-6(CL Ondich Rd)	TEMPORARY OH TRANSMISSION STRUCTURE TO BE REMOVED	Special conditions number 9 & 15	TBD	2

CENTRAL FLORIDA EXPRESSWAY AUTHORITY
UTILITY WORK SCHEDULE

UTILITIES
8/11/2015
7 of 7

Project Title: Wekiva Parkway - Segment 2B		County Road Number: N/A		
State Road No: 429		City Road: N/A		
		Project No: 429-204		
UTILITY AGENCY/OWNER (UAO): Duke Energy Transmission				
C.	Disposition of Facilities (List All Existing & Proposed) on Project:			
UTILITY FACILITIES by TYPE/SIZE/MATERIAL/OFFSET TO BASELINE FROM STA TO STA	DESCRIPTION OF UTILITY WORK	DEPENDENT ACTIVITIES	M.O.T. Phase Number	CONSECUTIVE CALENDAR DAYS
114+40 R125; T-5(CL Ondich Rd)	TEMPORARY OH TRANSMISSION STRUCTURE TO BE REMOVED	Special condition numbers 9 &15	TBD	2
118+99 R141; T-4(CL Ondich Rd)	TEMPORARY OH TRANSMISSION STRUCTURE TO BE REMOVED	Special condition numbers 9 & 15	TBD	2
106+49 R143; T-3(CL Plymouth- Sorrento Rd)	TEMPORARY OH TRANSMISSION STRUCTURE TO BE REMOVED	Special conditions numbers 9 & 15	TBD	2
109+15 R147; T-2(CL Plymouth- Sorrento Rd)	TEMPORARY OH TRANSMISSION STRUCTURE TO BE REMOVED	Special condition numbers 9 & 15	TBD	2
113+49 R142; T-1(CL Plymouth- Sorrento Rd)	TEMPORARY OH TRANSMISSION STRUCTURE TO BE REMOVED	Special condition numbers 9 & 15	TBD	2