

FOR IMMEDIATE RELEASE
 March 28, 2016

CONTACT: Megan Olivera
 Public Information Officer
 407-383-5817
construction@CFXway.com

SR 408 WIDENING COMMUNITY OPEN HOUSE SCHEDULED

(ORLANDO, FL) - The [Central Florida Expressway Authority](#) (CFX) has scheduled a public meeting for the [State Road 408 \(Spessard L. Holland East-West Expressway\)](#) widening project from Good Homes Road to east of Hiawasse Road. This two-mile project will add a travel lane in both directions (from two to three lanes) and will widen the ramp from westbound [SR 408](#) to Good Homes Road from one lane to two lanes.

The informal meeting will be held in an open-house format on **Thursday, March 31, 2016 from 5:00 p.m. to 7:00 p.m.** at Central Florida Christian Academy, 700 Good Homes Road, Orlando, FL 32818. The public will be able to review maps, drawings and other project information, and provide comments. Members of the project team will be available to answer questions.

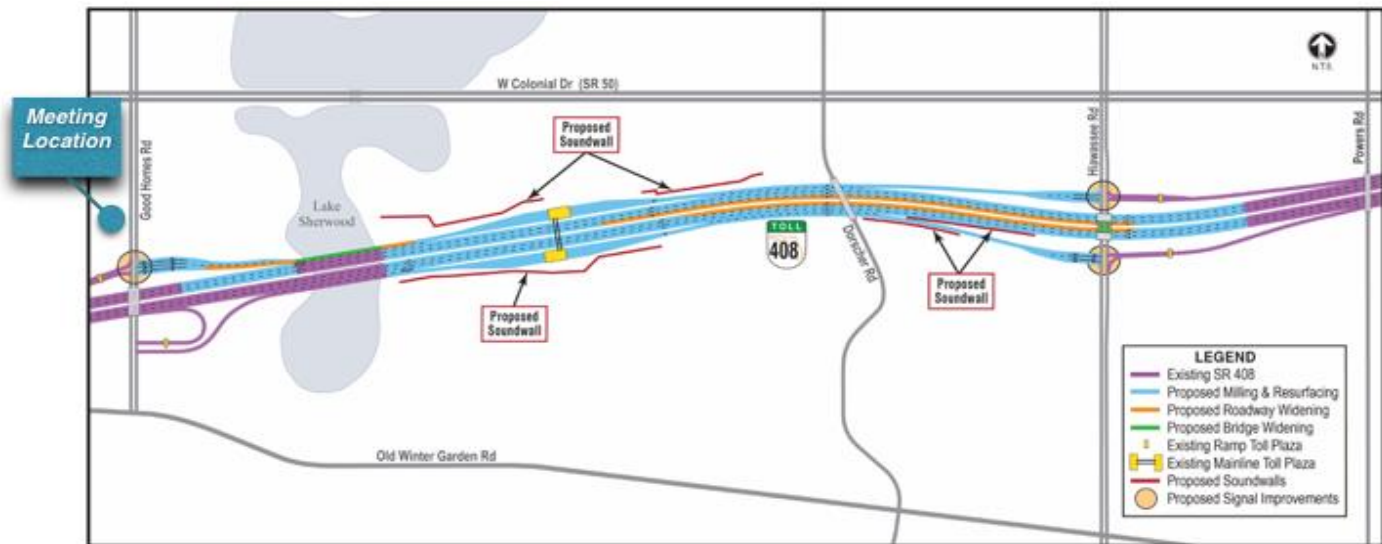

Contact Megan Olivera, Public Information Office, for open-house information or requests for special accommodations under the American with Disabilities Act of 1990. Ms. Olivera can be reached at 407-383-5817 or via email at construction@CFXway.com. Special accommodations requests under the American with Disabilities ACT should be made at least seven days prior to the meeting.

Construction on this estimated \$17 million project is scheduled to begin in summer 2016 and finish in late 2017. Please see the attached Fact Sheet for details.

The [Central Florida Expressway Authority's](#) jurisdiction includes Orange, Seminole, Lake, and Osceola Counties. CFX is responsible for the construction, maintenance and operation of a 109-mile limited-access expressway system. It may also acquire, construct and equip rapid transit, trams and fixed guideways within its rights-of-way. CFX's system includes SR 408 (Spessard Holland East- West Expressway), SR 528 (Martin Andersen Beachline Expressway), SR 417 (Central Florida GreeneWay), SR 429 (Daniel Webster Western Beltway), SR 414 (John Land Apopka Expressway) and State Road 451.