

Annual Inspection Report

2014



CENTRAL FLORIDA EXPRESSWAY AUTHORITY

Table of Contents

<u>Section</u>	<u>Title</u>	<u>Page</u>
	Executive Summary	E-1
1	Introduction.....	1-1
	1.1 Background	1-1
	1.2 Expressway Authority's Maintenance Program.....	1-2
2	Rating Systems	2-1
	2.1 Roadway Rating System	2-1
	2.2 Building Rating System	2-3
	2.3 Bridge Rating System.....	2-3
	<i>Roadway and Building Inspection Samples, and the Bridge Inspection Summary are included as part of this section.</i>	
3	Inspection Results	3-1
	3.1 Summary of Findings for Roadways, Buildings and Bridges	3-1
	3.1.1 SR 408 (East-West Expressway).....	3-4
	3.1.2 SR 414 (John Land Apopka Expressway).....	3-8
	3.1.3 SR 417 (Central Florida GreeneWay)	3-12
	3.1.4 SR 429 (Daniel Webster Western Beltway).....	3-17
	3.1.5 SR 451	3-21
	3.1.6 SR 528 (Beachline Expressway)	3-24
	3.2 Critical Items Summary.....	3-27
	<i>Sample Critical Item Alerts are included as part of this section.</i>	

List of Tables

<u>Table</u>	<u>Title</u>	<u>Page</u>
1	Rating System for Roadways and Buildings	2-1
2	Systemwide Summary of Findings	3-1

List of Figures

<u>Figure</u>	<u>Title</u>	<u>Page</u>
1-1	SR 408, SR 414, SR 417, SR 429, SR 451 and SR 528 Toll Facilities.....	1-5
1-2	Systemwide Mile Post Locations	1-6
3-1	SR 408 (East-West Expressway) Mile Post	3-3
3-2	SR 414 (John Land Apopka Expressway) Mile Post	3-7
3-3	SR 417 (Central Florida GreeneWay) Mile Post.....	3-10
3-4	SR 417 (Central Florida GreeneWay) Mile Post.....	3-11
3-5	SR 429 (Daniel Webster Western Beltway) Mile Post.....	3-16
3-6	SR 451 Mile Post.....	3-20
3-7	SR 528 (Beachline Expressway) Mile Post.....	3-23

Roadway and Building Inspection Worksheets are included on the compact disk (CD) attached to the back cover of this report. Instructions for viewing the disk are also included as the last page in this report.

2014 Annual Inspection Report



Executive Summary

CENTRAL FLORIDA EXPRESSWAY AUTHORITY

Executive Summary

The 2014 inspection of the Central Florida Expressway Authority's (Expressway Authority) system, performed by Atkins, the Authority's General Engineering Consultant, included a visual inspection of the roadways, buildings and bridges under Expressway Authority jurisdiction.

The Expressway Authority's roadway system includes SR 408 (East-West Expressway), SR 414 (John Land Apopka Expressway), SR 417 (Central Florida GreeneWay) from International Drive to the Seminole County line, SR 429 (Daniel Webster Western Beltway) from Seidel Road to US 441, SR 451 from SR 414 to US 441, and SR 528 (Beachline Expressway) from McCoy/Boggy Creek Road to SR 520. The system consists of 109 centerline miles of highway with 60 interchanges, 14 mainline toll plazas, 64 ramp toll plazas, and 291 bridges. The Expressway Authority also operates a non-system, two-mile tolled expressway (Goldenrod Extension) with one mainline plaza. The inspection results for the Goldenrod Extension are included under separate cover.

The findings of the 2014 inspection concluded that the Expressway Authority's roadway system is in good condition, with an average rating of 8 out of 10. This includes Roadway/Pavement, Roadside, Traffic Services, Drainage and Vegetation/Aesthetics features.

The overall appearance of the Expressway Authority's toll facilities and buildings along SR 408, SR 414, SR 417, SR 429, SR 451 and SR 528 remains generally good, with an average rating of 8 out of 10.

As reported for the Florida Transportation Commission (FTC) performance measures, 99.3% of the bridges on the Expressway Authority's system are rated excellent or good.

The findings, summarized in the 2014 Annual Inspection Report, reflect the condition of the feature(s) on the day the inspection was performed. Many of the deficiencies noted have been corrected subsequent to the inspection as part of the Maintenance Program currently administered by the Expressway Authority.

Rating systems were used to evaluate the condition of the roadways, buildings and bridges on the Expressway Authority's system. A ten (10) point rating system was used for the roadways and buildings, where 10 is excellent or "like new" condition and 1 is emergency or unacceptable and requires immediate maintenance. Features receiving a rating of 3 or lower are considered deficient and require action from the Expressway Authority's maintenance contractor. For features receiving a rating of 4, action is recommended before the feature becomes deficient. Features receiving a rating of 5 are considered degraded due to age and should be evaluated for inclusion in a future Renewal and Replacement (R&R) project. Bridges are rated on a four (4) point scale where 1 is excellent and 4 is poor.

Bridge inspections are conducted by Certified Bridge Inspectors under a program administered by the Florida Department of Transportation (FDOT) and funded by the Expressway Authority. Inspection results are published every two years on each bridge. No load limits or weight

restrictions have been imposed that would constrain the use of any bridge on the Expressway Authority's system.

This report will serve as a tool for the Expressway Authority to identify and prioritize the areas of the system that are in need of maintenance. The deficiencies identified in this year's report can be corrected through maintenance contracts as part of the Expressway Authority's Maintenance Program.

2014 Annual Inspection Report



Section 1 Introduction

CENTRAL FLORIDA EXPRESSWAY AUTHORITY

1. Introduction

1.1 Background

Between July and October 2014, Atkins, the Central Florida Expressway Authority's (Expressway Authority) General Engineering Consultant, conducted the annual inspection of the Expressway Authority's system as required by Article V, Section 5.12 (C) of the Amended and Restated Master Bond Resolution.

The Expressway Authority's roadway system includes SR 408 (East-West Expressway), SR 414 (John Land Apopka Expressway), SR 417 (Central Florida GreeneWay) from International Drive to the Seminole County line, SR 429 (Daniel Webster Western Beltway) from Seidel Road to US 441, SR 451 from SR 414 to US 441, and SR 528 (Beachline Expressway) from McCoy/Boggy Creek Road to SR 520. The system consists of 109 centerline miles of highway with 60 interchanges, 14 mainline toll plazas, 64 ramp toll plazas, and 291 bridges. The Expressway Authority also operates a non-system, two-mile tolled expressway (Goldenrod Extension) with one mainline toll plaza. The inspection results for the Goldenrod Extension are included under separate cover.

The Expressway Authority's system was examined by means of a visual inspection. The 2014 Annual Inspection Report summarizes the findings of these examinations by category:

- Roadways
- Buildings
- Bridges

Each category has been divided into segments corresponding to the roadway being inspected (SR 408, SR 414, SR 417, SR 429, SR 451 and SR 528). Figure 1-1 depicts the Expressway Authority's system and toll facilities. For purposes of reporting, the roadway inspection references mile post locations. The mile post locations on the Expressway Authority's system can be found in Figure 1-2.

Rating systems were used to evaluate the condition status of roadways, buildings, and bridges. The procedures for these rating systems are summarized in Section 2.

The inspection results, summarized in Section 3, reflect the condition of the feature(s) on the day the inspection was performed. Many of the deficiencies noted have already been corrected as part of the Expressway Authority's Maintenance Program.

At the time the 2014 inspection was performed, the following major construction projects were underway:

- SR 417 at Florida's Turnpike Interchange
- SR 417 at Boggy Creek Road Interchange

- SR 417 Widening from Curry Ford Road to Lake Underhill Road
- SR 429 at Schofield Road Interchange
- Systemwide Asphalt Friction Course Repairs

As a result, some of these portions of the roadway were not inspected. Section 3 of this report identifies the specific roadway sections that were not inspected due to construction activities.

1.2 Expressway Authority's Maintenance Program

Highway Maintenance Program

The Expressway Authority's fiscal year¹ (FY) 2015 Highway Maintenance Fund is budgeted at \$10.6 million for maintenance administration, routine maintenance, and Florida Department of Transportation (FDOT) services.

The Expressway Authority employs two contractors to perform asset maintenance management services for roadways and bridges. One contractor maintains SR 408, SR 417 and SR 528, while the other maintains SR 414, SR 429 and SR 451.

Building Maintenance Program

The toll facilities shown on Figure 1-1, as well as the Expressway Authority's headquarters building are maintained by a single contractor. The Expressway Authority's building maintenance budget for FY 2015 is approximately \$1.2 million.

Maintenance Program Overview

As part of the report preparation process, a representative of Atkins met with the Expressway Authority's Director of Construction and Maintenance to discuss the major achievements of the past fiscal year (FY 2014) and the goals and objectives for the coming fiscal year (FY 2015).

Staff identified the following major achievements during the past fiscal year (FY 2014):

- Continued management of the ongoing program for maintenance of the ITS infrastructure.
- Continued a landscape maintenance program to keep the aesthetics of the system at the highest levels.
- Continued a modified aquatic maintenance program to make stormwater ponds an aesthetic feature and part of the roadway landscape.

¹ The Expressway Authority's 2015 fiscal year runs from July 1, 2014 to June 30, 2015.

- Continued replacement and upgrades of retro-reflective pavement markers (RPM) that display less than satisfactory reflectivity.
- Implemented the next phase of the systemwide signing upgrades and rehabilitation in compliance with Federal Highway Administration (FHWA) requirements.
- Performed pavement inspections that identified areas that were raveling and/or damaged and required maintenance. These repairs are necessary to extend the pavement life in order to meet the planned and programmed milling and resurfacing schedules based on the Five Year Work Plan and the Pavement Management Program.
- Performed detailed inspections of systemwide fencing multiple times per year to help ensure that unauthorized access to the Expressway Authority right-of-way through damaged or missing fence sections is minimized.
- Identified the generators and air conditions at the toll plazas that have reached their expected useful life and need to be replaced versus those that need maintenance to extend their life and identified funding sources.
- Developed a roof replacement program based on results of the roof inspections and determined repair needs to maintain life expectancy for roofs in need of maintenance.
- Attained a Final Annual Maintenance Rating Program (MRP) score from the FDOT of 92 out of 100.

Expressway Authority staff has identified the following goals and objectives for the coming fiscal year (FY 2015). These items primarily involve the physical activities associated with construction and maintenance of roadways, bridges and toll plaza facilities:

- Maintain a Maintenance Rating Program (MRP) score from the FDOT of at least 91.
- Continue the next phase of replacement and upgrades of retro-reflective pavement markers (RPM).
- Implement the next phase of systemwide signing upgrades and rehabilitation.
- Continue to perform periodic detailed inspections of systemwide fencing.
- Continue to identify those projects that should be funded under the Renewal and Replacement (R&R) budget and those projects that are clearly routine maintenance and should be included in the maintenance budget.
- Analyze the observations from Florida Highway Patrol (FHP), Road Ranger program and fiber optic locators to enhance surveillance and maintenance of the Expressway Authority's system.

- Maintain pavement striping at a high level of reflectivity and replace unsatisfactory striping where needed.
- Keep the roadway, roadside and aesthetic features maintained at the highest possible levels. For those portions of the Expressway Authority's system under construction, identify problem areas (e.g. shoulder and barrier wall inlets blocked with debris; pot holes; washouts, etc.) and advise the appropriate construction contractors through the Expressway Authority representative.
- Continue to monitor systemwide generators and air conditioners and determine needed repairs.
- Continue to monitor systemwide roof performance to determine needed repairs.
- Continue to use the Annual Inspection findings as a tool to aid in determining maintenance needs versus future renewal and replacement projects.
- Continue to address deficiencies identified in the FDOT bridge inspections reports in a timely manner. FDOT gives a priority of 1 through 4 to the identified deficiencies. Priority 1 requires the work be done in 60 days, priority 2 in 180 days, priority 3 in 365 days, and priority 4 in 2 years.
- Continue to monitor FDOT bridge performance ratings and take action as necessary. FDOT assigns performance rating factors of 1 through 4, where 1 is excellent, 2 is good, 3 is fair, and 4 is poor.

In addition to goals and objectives for the physical activities associated with construction and maintenance of roadways, bridges and toll plaza facilities, staff has identified goals and objectives related to program, process and procedural initiatives for the coming year. The ultimate purpose of these initiatives is to provide the Expressway Authority's customers with a smooth ride and aesthetically pleasing surroundings creating a unique driving experience that will be immediately identifiable with an Expressway Authority roadway. These initiatives are:

- Meet with FDOT District 5 and Florida Turnpike Enterprise (FTE) personnel on an as-needed basis to discuss maintenance and other issues of mutual importance to both agencies.
- Evaluate and enhance the Expressway Authority's program to manage its assets to provide maximum control over the timing and implementation of replacement programs and initiatives.
- Provide a timely response to customer feedback on maintenance issues.

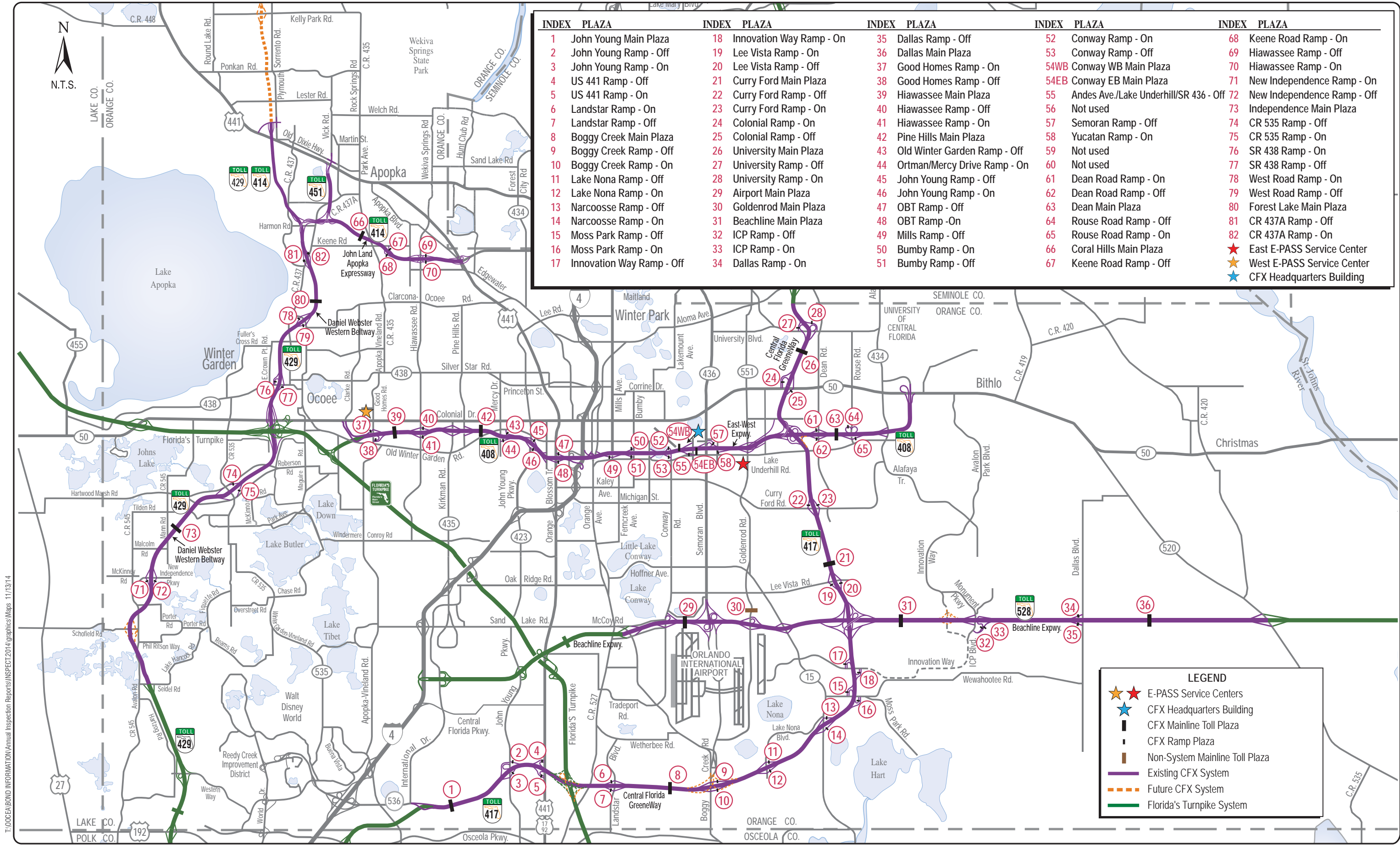

T:\OCEA\BOND INFORMATION\Annual Inspection Reports\INSPECT\2014\graphics\Maps 11/13/14

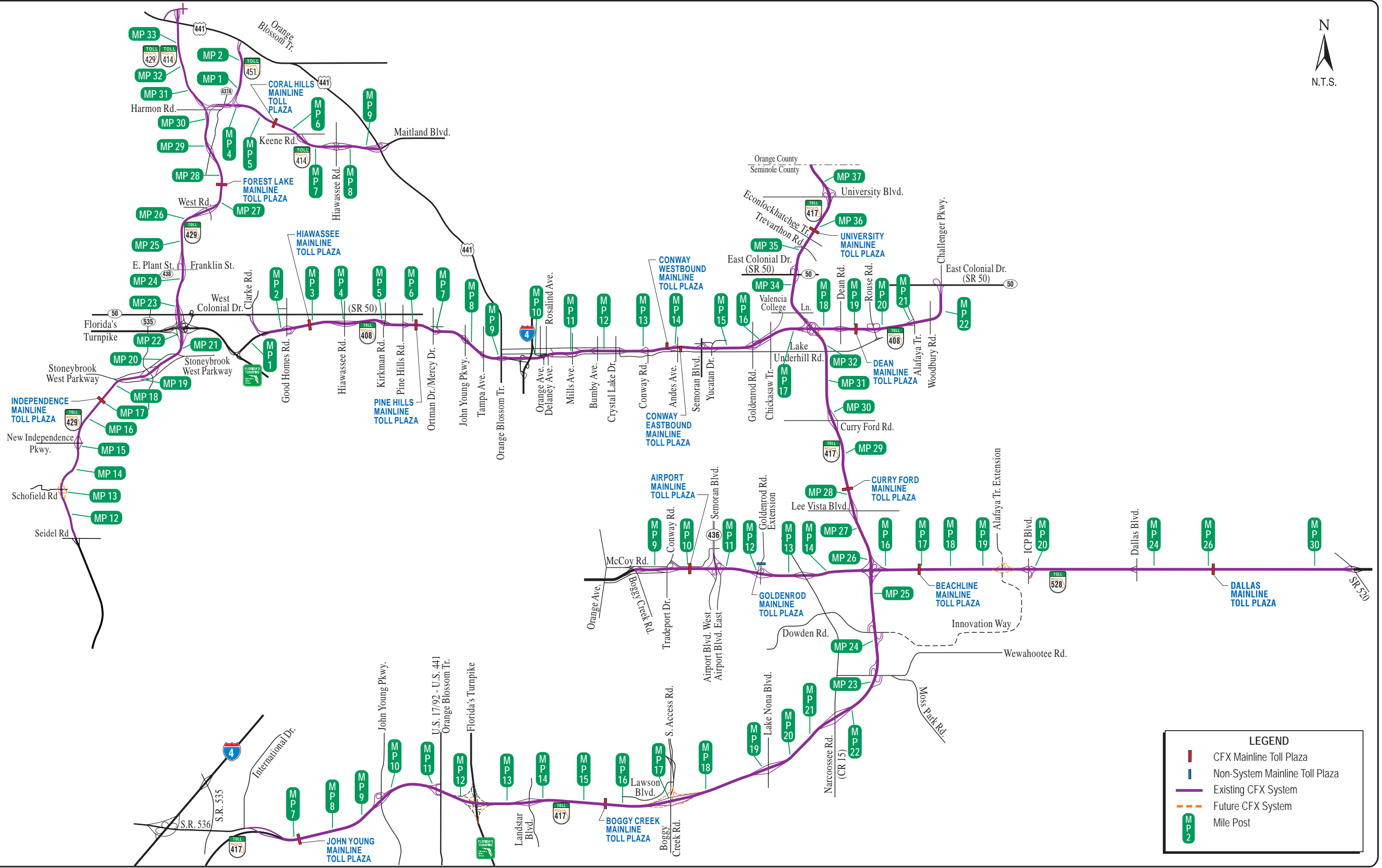

2014 Annual Inspection Report



Section 2 Rating Systems

CENTRAL FLORIDA EXPRESSWAY AUTHORITY

2. Rating Systems

2.1 Roadway Rating System

The roadway rating system used for the annual inspection includes an in-depth review of 49 features divided into five groups: Roadway/Pavement, Roadside, Traffic Services, Drainage and Vegetation/Aesthetics. Table 1 shows the rating system used for the roadways and buildings.

Table 1: Rating System for Roadways and Buildings

Rating	Description	Comment	Feature appearance and functionality / operability	Action required / recommended
0	Under Construction	Location not inspected.	-	-
1	Emergency	Immediate maintenance is required to protect public or system.	Unacceptable	10 days or less (Required)
2-3	Unsatisfactory	Maintenance is required to protect public or system.	Poor	90 days or less (Required)
4	Degraded (due to maintenance)	Improve maintenance to protect feature.	Below Average	180 days or less (Recommended)
5	Degraded (due to age)	Evaluate for future R&R project.	Average	-
6-7	Fair	Continue to monitor feature.	Satisfactory / Fair	-
8-9	Good	No deficiencies noted. No maintenance necessary.	Satisfactory / Good Condition	-
10	Excellent	No deficiencies noted.	“Like New” condition	-
NI	Not Inspected	Inaccessible location	-	-
N/A	Not Applicable	Feature does not apply at this location	-	-

Anything rated below a 3 will trigger a response from the Expressway Authority’s maintenance contractor and require action to improve the feature. For features receiving a rating of 4, action is recommended before they become deficient. Features receiving a rating of 5 are considered degraded due to age and should be evaluated for inclusion in a future Renewal and Replacement project. For reporting purposes, the deficiencies noted in Section 3 of this report are those features rated 3 or below.

The groups and features inspected include:

1. **Roadway/Pavement** – Includes all features/deficiencies found in the pavement area. It includes the visual review of pavement condition with particular attention directed towards the presence of potholes, edge ravel, and similar deficiencies.
 - a. Bridge
 - b. Cracking
 - c. Depression
 - d. Edge Ravel
 - e. Joint
 - f. Paved Shoulder
 - g. Pavement Void
 - h. Pothole
 - i. Rutting
 - j. Shoving
 - k. Stripping
2. **Roadside** – Includes the evaluation of features found along the roadside not associated with drainage or vegetation/aesthetics.
 - a. Back Slope
 - b. Fence
 - c. Front Slope
 - d. Rip Rap
 - e. Sidewalk
 - f. Slope Protection
 - g. Soil Shoulder
 - h. Turnout
3. **Traffic Services** – Includes the evaluation of features that guide, protect and assist the drivers. Highway and sign lighting were inspected at night. Sign reflectivity was not rated as part of the visual inspection. Sign reflectivity is being assessed and will be reported separately.
 - a. Attenuator
 - b. Barrier Wall
 - c. Guardrail
 - d. Highway Lighting
 - e. Information Sign
 - f. Object Marker
 - g. Pavement Marker
 - h. Pavement Symbol
 - i. Regulatory Sign
 - j. Sign Light
 - k. Striping
 - l. Warning Sign
4. **Drainage** – Includes the evaluation of drainage structures and associated appurtenances.
 - a. Cross Drain
 - b. Curb Inlet
 - c. Median Ditch
 - d. Miscellaneous Drain
 - e. Miscellaneous Inlet
 - f. Other Inlet
 - g. Outfall Ditch
 - h. Pond / Lake / Canal
 - i. Roadside Ditch
 - j. Side Drain
 - k. Storm Drain
5. **Vegetation/Aesthetics** – Includes the evaluation of features found along the roadside. These features tend to have a high visual influence on travelers.

- | | | | |
|----|----------------|----|----------------|
| a. | Landscaping | e. | Slope Mowing |
| b. | Litter Removal | f. | Tree Trim |
| c. | Roadway Mowing | g. | Turf Condition |
| d. | Roadway Sweep | | |

A sample of an actual roadway inspection worksheet is included at the end of this section. All reports are included on the Roadway Inspection Worksheets on the CD attached at the end of this report.

2.2 Building Rating System

The building inspection included all mainline and ramp toll plaza buildings along the Expressway Authority's system, as well as the Expressway Authority's headquarters building in ORL Tower Road. Building components such as grounds, building exterior and interior, lights, restrooms, signs and equipment were divided into a number of subcomponents and rated as shown in Table 1.

Anything rated below a 3 will trigger a response from the Expressway Authority's maintenance contractor and require action to improve the feature. For features receiving a rating of 4, action is recommended before they become deficient. Features receiving a rating of 5 should be evaluated for inclusion in a future Renewal and Replacement project. For reporting purposes, the deficiencies noted in Section 3 of this report are those features rated 3 or below.

A sample of an actual building inspection worksheet is included at the end of this section. All reports are included on the Building Inspection Worksheets on the CD attached to the back of this report.

2.3 Bridge Rating System

Inspections of the bridges on the Expressway Authority's system are conducted by Certified Bridge Inspectors under a program administered by the FDOT and funded by the Expressway Authority. Detailed Bridge Inspection Reports are prepared and filed every two years for each bridge. The most current bridge ratings were received from FDOT in September 2014.

The Performance Rating rates the condition of the bridge. It is auto-calculated and is based on the lowest rating for Deck, Superstructure and Substructure. For culverts, the rating is based on the Culvert Rating. The performance rating factors are as follows:

1 = Excellent
2 = Good

3 = Fair
4 (and above) = Poor

The bridge inspection summary is included at the end of this section. Detailed bridge inspection reports are available for review upon written request to the Expressway Authority.

Roadway Inspection Sample



2014 - Central Florida Expressway Authority

Report of all Roadway features

Prepared by:

ATKINS

John Land Apopka Expressway - Eastbound

Milepost location	Rating	Item	Comments
M.P. 002.864 to M.P. 003			
.864-.999	8	Turf Condition	No deficiencies noted
.864-.999	8	Soil Shoulder	No deficiencies noted
.864-.999	8	Roadside Ditch	No deficiencies noted
.864-.999	8	Pond Lake Canal	No deficiencies noted
.864-.999	8	Other Inlet	No deficiencies noted
.864-.999	8	Median Ditch	No deficiencies noted
.864-.999	8	Front Slope	No deficiencies noted
.864-.999	8	Tree Trim	No deficiencies noted
.864-.999	8	Slope Mowing	No deficiencies noted
.864-.999	8	Roadway Mowing	No deficiencies noted
.864-.999	8	Litter Removal	No deficiencies noted
.864-.999	9	Cracking	No deficiencies noted
.864-.999	9	Roadway Sweep	No deficiencies noted
.864-.999	9	Storm Drain	No deficiencies noted
.864-.999	9	Slope Protection	No deficiencies noted
.864-.999	9	Warning Sign	No deficiencies noted
.864-.999	9	Cross Drain	No deficiencies noted
.864-.999	9	Pothole	No deficiencies noted
.864-.999	9	Fence	No deficiencies noted
.864-.999	9	Pavement Symbol	No deficiencies noted
.864-.999	9	Depression	No deficiencies noted
.864-.999	9	Guardrail	No deficiencies noted
.864-.999	9	Stripping	No deficiencies noted
.864-.999	9	Pavement Marker	No deficiencies noted
.864-.999	9	Rutting	No deficiencies noted



2014 - Central Florida Expressway Authority

Report of all Roadway features

Prepared by:

ATKINS

John Land Apopka Expressway - Eastbound

Milepost location	Rating	Item	Comments
M.P. 002.864 to M.P. 003			
.864-.999	9	Object Marker	No deficiencies noted
.864-.999	9	Pavement Void	No deficiencies noted
.864-.999	9	Regulatory Sign	No deficiencies noted
.864-.999	9	Paved Shoulder	No deficiencies noted
.864-.999	9	Striping	No deficiencies noted
.864-.999	9	Joint	No deficiencies noted
.864-.999	9	Edge Ravel	No deficiencies noted
.864-.999	9	Shoving	No deficiencies noted
.864-.999	10	Information Sign < 30	No deficiencies noted
.864-.999	10	Information Sign > 30	No deficiencies noted
M.P. 003 to M.P. 004			
.000	4	Object Marker	Milepost sign 3 is missing.
.000-.999	8	Roadway Mowing	No deficiencies noted
.000-.999	8	Roadside Ditch	No deficiencies noted
.000-.999	8	Turf Condition	No deficiencies noted
.000-.999	8	Tree Trim	No deficiencies noted
.000-.999	8	Soil Shoulder	No deficiencies noted
.000-.999	8	Slope Mowing	No deficiencies noted
.000-.999	8	Roadway Sweep	No deficiencies noted
.000-.999	8	Litter Removal	No deficiencies noted
.000-.999	8	Median Ditch	No deficiencies noted
.000-.999	9	Other Inlet	No deficiencies noted
.000-.999	9	Depression	No deficiencies noted
.000-.999	9	Cracking	No deficiencies noted
.000-.999	9	Shoving	No deficiencies noted



2014 - Central Florida Expressway Authority

Report of all Roadway features

Prepared by:

ATKINS

John Land Apopka Expressway - Eastbound

Milepost location	Rating	Item	Comments
M.P. 003 to M.P. 004			
.000-.999	9	Rutting	No deficiencies noted
.000-.999	9	Fence	No deficiencies noted
.000-.999	9	Pothole	No deficiencies noted
.000-.999	9	Pavement Symbol	No deficiencies noted
.000-.999	9	Paved Shoulder	No deficiencies noted
.000-.999	9	Front Slope	No deficiencies noted
.000-.999	9	Edge Ravel	No deficiencies noted
.000-.999	9	Cross Drain	No deficiencies noted
.000-.999	9	Pavement Void	No deficiencies noted
.000-.999	9	Pond Lake Canal	No deficiencies noted
.000-.999	9	Pavement Marker	No deficiencies noted
.000-.999	9	Warning Sign	No deficiencies noted
.000-.999	9	Regulatory Sign	No deficiencies noted
.000-.999	9	Joint	No deficiencies noted
.000-.999	9	Striping	No deficiencies noted
.000-.999	9	Stripping	No deficiencies noted
.000-.999	9	Guardrail	No deficiencies noted
.000-.999	9	Storm Drain	No deficiencies noted
.000-.999	10	Slope Protection	No deficiencies noted
.000-.999	10	Information Sign > 30	No deficiencies noted
.000-.999	10	Information Sign < 30	No deficiencies noted
M.P. 004 to M.P. 005			
.948	5	Tree Trim	Tree limbs overhanging barrier wall.
.358-.398	6	Paved Shoulder	Grass growing throughout paved shoulder
.998	6	Tree Trim	Dead tree laying across fence. (Fence damage)



2014 - Central Florida Expressway Authority

Report of all Roadway features

Prepared by:

ATKINS

John Land Apopka Expressway - Eastbound

Milepost location	Rating	Item	Comments
M.P. 004 to M.P. 005			
.000-.999	8	Object Marker	No deficiencies noted
.000-.999	8	Storm Drain	No deficiencies noted
.000-.999	8	Soil Shoulder	No deficiencies noted
.000-.999	8	Slope Mowing	No deficiencies noted
.000-.999	8	Roadway Sweep	No deficiencies noted
.000-.999	8	Roadside Ditch	No deficiencies noted
.000-.999	8	Pond Lake Canal	No deficiencies noted
.000-.999	8	Roadway Mowing	No deficiencies noted
.000-.999	8	Turf Condition	No deficiencies noted
.000-.999	8	Cross Drain	No deficiencies noted
.000-.999	8	Litter Removal	No deficiencies noted
.000-.999	8	Median Ditch	No deficiencies noted
.000-.999	8	Fence	No deficiencies noted
.000-.999	8	Front Slope	No deficiencies noted
.000-.999	8	Guardrail	No deficiencies noted
.000-.999	9	Rutting	No deficiencies noted
.000-.999	9	Warning Sign	No deficiencies noted
.000-.999	9	Depression	No deficiencies noted
.000-.999	9	Edge Ravel	No deficiencies noted
.000-.999	9	Stripping	No deficiencies noted
.000-.999	9	Striping	No deficiencies noted
.000-.999	9	Slope Protection	No deficiencies noted
.000-.999	9	Pavement Void	No deficiencies noted
.000-.999	9	Cracking	No deficiencies noted
.000-.999	9	Barrier Wall	No deficiencies noted



2014 - Central Florida Expressway Authority

Report of all Roadway features

Prepared by:

ATKINS

John Land Apopka Expressway - Eastbound

Milepost location	Rating	Item	Comments
M.P. 004 to M.P. 005			
.000-.999	9	Regulatory Sign	No deficiencies noted
.000-.999	9	Pothole	No deficiencies noted
.000-.999	9	Joint	No deficiencies noted
.000-.999	9	Pavement Symbol	No deficiencies noted
.000-.999	9	Pavement Marker	No deficiencies noted
.000-.999	9	Shoving	No deficiencies noted
.000-.999	10	Information Sign < 30	No deficiencies noted
.000-.999	10	Information Sign > 30	No deficiencies noted
M.P. 005 to M.P. 006			
.207,.224	4	Joint	Joint edges are spalled and joint material is deteriorated.
.042-.105	5	Paved Shoulder	Paved shoulder exhibits cracking
.231	5	Paved Shoulder	Paved shoulder and barrier wall has been scarred by vehicle fire.
.000-.999	8	Rutting	No deficiencies noted
.000-.999	8	Pavement Void	No deficiencies noted
.000-.999	8	Stripping	No deficiencies noted
.000-.999	8	Depression	No deficiencies noted
.000-.999	8	Warning Sign	No deficiencies noted
.000-.999	8	Cracking	No deficiencies noted
.000-.999	8	Edge Ravel	No deficiencies noted
.000-.999	8	Barrier Wall	No deficiencies noted
.000-.999	8	Object Marker	No deficiencies noted
.000-.999	8	Pavement Marker	No deficiencies noted
.000-.999	8	Pavement Symbol	No deficiencies noted
.000-.999	8	Striping	No deficiencies noted
.000-.999	8	Information sign < 30	No deficiencies noted.



2014 - Central Florida Expressway Authority

Report of all Roadway features

Prepared by:

ATKINS

John Land Apopka Expressway - Eastbound

Milepost location	Rating	Item	Comments
M.P. 005 to M.P. 006			
.000-.999	8	Information sign > 30	No deficiencies noted.
.000-.999	8	Soil Shoulder	No deficiencies noted
.000-.999	8	Pothole	No deficiencies noted
.000-.999	8	Regulatory Sign	No deficiencies noted
.000-.999	8	Litter Removal	No deficiencies noted
.000-.999	8	Shoving	No deficiencies noted
.000-.999	8	Slope Protection	No deficiencies noted
.000-.999	8	Landscape	No deficiencies noted
.000-.999	8	Roadway Mowing	No deficiencies noted
.000-.999	8	Roadway Sweep	No deficiencies noted
.000-.999	8	Slope Mowing	No deficiencies noted
.000-.999	8	Tree Trim	No deficiencies noted
.000-.999	8	Turf Condition	No deficiencies noted
.000-.999	8	Guardrail	No deficiencies noted.
.000-.999	8	Cross Drain	No deficiencies noted.
.000-.999	8	Storm Drain	No deficiencies noted
.000-.999	8	Median Ditch	No deficiencies noted
.000-.999	8	Outfall Ditch	No deficiencies noted
.000-.999	8	Pond Lake Canal	No deficiencies noted
.000-.999	8	Rip Rap	No deficiencies noted
.000-.999	8	Roadside Ditch	No deficiencies noted
.000-.999	8	Side Drain	No deficiencies noted
.000-.999	8	Fence	No deficiencies noted
.000-.999	8	Front Slope	No deficiencies noted
.000-.999	8	Curb Inlet	No deficiencies noted

Building Inspection Sample



2014 - Central Florida Expressway Authority

Report of all facility features

Prepared by:

ATKINS



GreeneWay

Moss Park Rd - SB Off ramp

MP 030

Apron

Feature	Rating	Comments
Apron Sweep	9	No deficiencies noted
Cracking	9	No deficiencies noted
Joints	9	No deficiencies noted
Pavement Voids	9	No deficiencies noted
Striping	9	No deficiencies noted



2014 - Central Florida Expressway Authority

Report of all facility features

Prepared by:

ATKINS



GreeneWay

Moss Park Rd - SB Off ramp

MP 030

Canopy

Feature	Rating	Comments
Canopy Columns	9	No deficiencies noted
Canopy Fascia	9	No deficiencies noted
Canopy lighting	9	No deficiencies noted
Canopy Underside	9	No deficiencies noted
Sign Lighting	9	No deficiencies noted
Sign Structure	9	No deficiencies noted
Signs	9	No deficiencies noted
Steel Framing	9	No deficiencies noted
Traffic Red / Green Lighting	9	No deficiencies noted
Underdeck Lights	9	No deficiencies noted
Variable Message Signs	9	No deficiencies noted



2014 - Central Florida Expressway Authority

Report of all facility features

Prepared by:

ATKINS

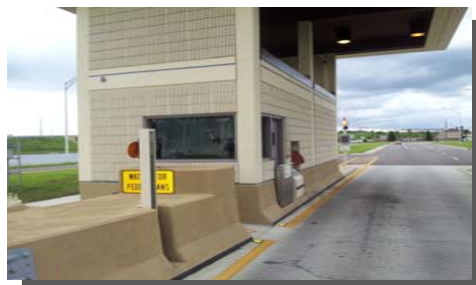

GreeneWay

Moss Park Rd - SB Off ramp

MP 030

Combo Bldg - Bldg Exterior

Feature	Rating	Comments
Joint Sealants	6	Vegetation growing through deteriorated joint sealant.
Windows and Storefronts	6	Frame finish exhibits peeling paint algae growth.
Site Grounds	8	No deficiencies noted
Concrete Pavement	9	No deficiencies noted
Condensing Units	9	No deficiencies noted
Doors / Frames (Interior and Exterior)	9	No deficiencies noted
Lighting (Exterior)	9	No deficiencies noted
Lightning Protection	9	No deficiencies noted
Nose Flashers	9	No deficiencies noted
Paint - Interior and Exterior	9	No deficiencies noted
Receptacle	9	No deficiencies noted
Security	9	No deficiencies noted
Signs	9	No deficiencies noted
Site Drainage	9	No deficiencies noted
Stand-By Generator	9	No deficiencies noted
Toll Indicator	9	No deficiencies noted
Transformers	9	No deficiencies noted
Walls (Concrete Block, Brick, Stucco or EIFS)	9	No deficiencies noted
Wiring	9	No deficiencies noted



2014 - Central Florida Expressway Authority

Report of all facility features

Prepared by:

ATKINS



GreeneWay

Moss Park Rd - SB Off ramp

MP 030

Combo Bldg - Collection Area

Feature	Rating	Comments
Flooring (Interior and Accessories)	5	Tiles are scuffed near ACM machine. Money laying on the floor.
Fire Extinguisher	8	No deficiencies noted
ACM	9	No deficiencies noted
Air Conditioners	9	No deficiencies noted
Ceilings and Ceiling Grids	9	No deficiencies noted
Counters/Cabinets and Drawers	9	No deficiencies noted
Doors / Frames (Interior and Exterior)	9	No deficiencies noted
Ductwork and Insulation	9	No deficiencies noted
HVAC Control Systems	9	No deficiencies noted
Joint Sealants	9	No deficiencies noted
Lighting (Interior)	9	No deficiencies noted
Paint - Interior and Exterior	9	No deficiencies noted
Panelboards	9	No deficiencies noted
Receptacle	9	No deficiencies noted
Security	9	No deficiencies noted
Switchboards and Breakers	9	No deficiencies noted
Telephone System	9	No deficiencies noted
TVSS (Transient Voltage Surge Suppressor)	9	No deficiencies noted
Ventilation Outlets	9	No deficiencies noted
Walls (Concrete Block, Brick, Stucco or EIFS)	9	No deficiencies noted



2014 - Central Florida Expressway Authority

Report of all facility features

Prepared by:

ATKINS



GreeneWay

Moss Park Rd - SB Off ramp

MP 030

Combo Bldg - Collection Area

Feature	Rating	Comments
Walls (Interior)	9	No deficiencies noted
Windows and Storefronts	9	No deficiencies noted
Wiring	9	No deficiencies noted



2014 - Central Florida Expressway Authority

Report of all facility features

Prepared by:

ATKINS



GreeneWay

Moss Park Rd - SB Off ramp

MP 030

Combo Bldg - Recorder Room

Feature	Rating	Comments
Switchboards and Breakers	3	Labeling / directory is incorrect in panel EDR
Lighting (Interior)	4	Emergency lighting is not working.
Air Conditioners	8	No deficiencies noted
Fire Extinguisher	8	No deficiencies noted
Ceiling	9	No deficiencies noted
Doors / Frames (Interior and Exterior)	9	No deficiencies noted
Ductwork and Insulation	9	No deficiencies noted
Flooring (Interior and Accessories)	9	No deficiencies noted
HVAC Control Systems	9	No deficiencies noted
Paint - Interior and Exterior	9	No deficiencies noted
Panelboards	9	No deficiencies noted
Receptacle	9	No deficiencies noted
UPS (Uninterrupted Power Supply)	9	No deficiencies noted
Ventilation Outlets	9	No deficiencies noted
Walls (Interior)	9	No deficiencies noted
Wiring	9	No deficiencies noted



2014 - Central Florida Expressway Authority

Report of all facility features

Prepared by:
ATKINS

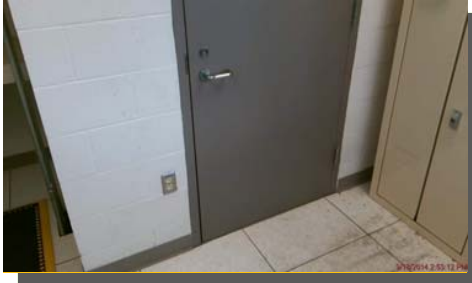

GreeneWay

Moss Park Rd - SB Off ramp

MP 030

Combo Bldg - Restroom

Feature	Rating	Comments
Restroom	NI	Not Inspected. Door is locked.



2014 - Central Florida Expressway Authority

Report of all facility features

Prepared by:

ATKINS



GreeneWay

Moss Park Rd - SB Off ramp

MP 030

Island A - Island

Feature	Rating	Comments
Attenuator	9	No deficiencies noted
Concrete	9	No deficiencies noted
Nose Flashers	9	No deficiencies noted
Paint - Interior and Exterior	9	No deficiencies noted
Sign Structures	9	No deficiencies noted
Signs	9	No deficiencies noted

Bridge Inspection Summary

Central Florida Expressway Authority
Bridge Ratings Summary
by Florida Department of Transportation
District 5

Bridge Number	Facility	Deck Rating	Superstructure Rating	Substructure Rating	Channel Rating	Culvert Rating	Structure Evaluation	Performance Rating
750055	SR-528	N	N	N	6	7	7	2
750056	SR-528	6	7	6	N	N	6	2
750057	SR-528 WB	7	7	6	5	N	6	2
750058	SR-528	6	7	7	N	N	7	2
750059	SR-528 WB	6	7	7	N	N	7	2
750100	SR-408 WB	7	7	7	N	N	7	2
750102	SR-408 WB	7	7	7	N	N	7	2
750103	SR-408 WB	7	7	7	N	N	7	2
750104	SR-408 WB	7	7	7	N	N	7	2
750106	SR-408	7	7	7	N	N	7	2
750107	SR-408 WB	7	7	7	N	N	7	2
750108	SR-408 WB	7	7	7	N	N	7	2
750112	SR-408 Exit Ramp	7	7	7	N	N	7	2
750114	SR-408	6	7	7	7	N	7	2
750116	SR-408 WB	7	7	7	N	N	7	2
750119	SR-408 WB	7	7	7	N	N	7	2
750120	SR-408	7	7	7	N	N	7	2
750121	SR-408 WB	7	7	7	8	N	7	2
750123	SR-408 WB	7	7	7	N	N	7	2
750124	SR-408 WB	7	7	7	N	N	7	2
750126	SR-408 WB	7	7	7	N	N	7	2
750128	SR-408 WB	7	7	7	N	N	7	2
750129	SR-408	7	7	7	N	N	7	2
750130	I-4 Con. to SR-408	7	7	7	N	N	7	2
750137	I-4 Connector	7	7	7	N	N	7	2
750138	I-4 Connector	7	7	7	N	N	7	2
750179	SR-528	6	7	7	N	N	7	2
750182	SR-408 EB	7	7	7	N	N	7	2
750183	SR-408	6	7	7	9	N	7	2
750184	SR-408	7	7	7	N	N	7	2
750185	SR-408 EB	7	7	7	N	N	7	2
750186	SR-408 EB	7	7	7	N	N	7	2
750212	SR-528	7	7	6	5	N	6	2
750213	SR-528	7	7	7	N	N	7	2
750214	SR-528	7	7	7	N	N	7	2
750220	SR-408 EB	7	7	7	N	N	7	2
750231	SR-408 EB	7	7	7	N	N	7	2
750232	SR-408	7	7	7	N	N	7	2
750233	SR-408 EB	7	7	7	N	N	7	2
750234	SR-408 EB	7	7	7	N	N	7	2
750235	SR-408	7	7	7	N	N	7	2
750236	SR-408 EB	7	7	7	N	N	7	2
750237	SR-408 EB	7	7	7	N	N	7	2
750238	SR-408	7	7	7	N	N	7	2
750239	SR-408	7	8	7	N	N	7	2
750240	SR-408	7	7	7	N	N	7	2
750241	SR-408	7	7	7	N	N	7	2
750242	SR-408	7	7	7	N	N	4	2
750243	SR-408	7	7	7	N	N	7	2
750244	SR-408	7	7	7	N	N	4	2
750245	SR-408	7	7	7	N	N	6	2
750246	SR-408 EB	7	7	7	N	N	7	2
750247	SR-408 EB	7	7	7	7	N	7	2
750248	SR-408 EB	7	7	7	N	N	7	2
750249	SR-408 EB	7	7	7	N	N	7	2
750251	SR-408 WB	7	7	7	N	N	7	2
750252	SR-408 EB	7	7	7	N	N	7	2
750253	SR-408	7	7	7	N	N	7	2
750300	SR-528	N	N	N	7	6	6	2
750315	SR-436	5	7	7	N	N	7	3

Central Florida Expressway Authority
Bridge Ratings Summary
by Florida Department of Transportation
District 5

Bridge Number	Facility	Deck Rating	Superstructure Rating	Substructure Rating	Channel Rating	Culvert Rating	Structure Evaluation	Performance Rating
750316	SR-436	5	7	7	N	N	7	3
750317	SR-436 NB	6	7	7	N	N	7	2
750318	SR-528	9	7	7	N	N	7	2
750319	SR-528	9	7	7	N	N	7	2
750320	SR-528	9	7	7	N	N	7	2
750330	SR-528	N	N	N	7	6	6	2
750332	SR-528	7	7	7	N	N	7	2
750333	SR-528	6	7	7	N	N	7	2
750337	Chickasaw Trail	7	7	8	N	N	7	2
750342	SR-417 NB	7	7	7	N	N	7	2
750343	SR-417 SB	7	7	7	N	N	7	2
750344	SR-417 SB	7	7	7	7	N	7	2
750345	SR-417 NB	7	7	7	8	N	7	2
750346	Trevarthon Rd.	7	7	7	N	N	7	2
750347	Econlockhatcee Trl	7	8	8	N	N	8	2
750348	SR-417	7	7	7	N	N	7	2
750349	SR-417 NB	7	7	7	N	N	7	2
750350	SR-417 SB	7	7	7	N	N	7	2
750351	SR-417 NB	7	7	7	N	N	7	2
750352	SR-408 Ramp AR-2	7	8	7	N	N	7	2
750353	SR-408 Ramp AR-1	7	7	7	N	N	7	2
750354	SR-417	7	7	7	N	N	7	2
750355	SR-417	7	7	7	N	N	7	2
750356	Econlockhatchee Tr	7	7	7	N	N	7	2
750357	SR-408 WB	7	8	8	7	N	8	2
750358	SR-408 EB	7	7	7	7	N	7	2
750359	Dean Road	7	7	7	N	N	7	2
750360	SR-408 WB	7	7	7	N	N	7	2
750361	SR-408 EB	7	7	7	N	N	7	2
750362	SR-408 WB	7	7	7	N	N	7	2
750363	SR-408 EB	8	7	7	N	N	7	2
750364	Woodbury Road	7	7	7	N	N	7	2
750365	SR-408 WB	7	8	8	N	N	8	2
750366	SR-408 EB	7	7	7	N	N	7	2
750369	SR-408 EB	8	8	8	N	N	8	1
750370	SR-408 WB	8	8	8	N	N	8	1
750373	SR-417 Ramp SB	7	7	7	N	N	7	2
750374	SR-417 NB Ramp	7	7	7	N	N	7	2
750375	SR-417 SB	7	7	7	N	N	7	2
750376	SR-417 NB	7	7	7	N	N	7	2
750377	SR-417	N	N	N	7	6	6	2
750378	SR-417 SB	7	7	7	N	N	7	2
750379	SR-417 NB	8	7	7	N	N	7	2
750380	SR-417 SB	7	8	7	N	N	7	2
750381	SR-417 NB	8	8	8	N	N	8	1
750382	SR-417 SB	7	7	7	N	N	7	2
750383	SR-417 NB	8	8	8	N	N	8	1
750384	SR-417 SB	7	7	8	N	N	7	2
750385	SR-417 NB	7	7	7	N	N	7	2
750390	SR-408 EB	8	7	8	N	N	7	2
750391	SR-408	7	7	7	N	N	7	2
750392	Good Homes Road	7	7	7	N	N	7	2
750393	SR-408 WB	7	7	7	7	N	7	2
750394	SR-408 EB	7	7	7	7	N	7	2
750395	Dorscher Road	7	8	7	N	N	7	2
750396	SR-408 WB	7	7	7	N	N	5	2
750397	SR-408	7	7	7	N	N	5	2
750398	Powers Drive	7	6	8	N	N	6	2
750399	Paul Street	7	7	8	N	N	7	2
750406	SR-429 SB	7	8	7	N	N	7	2

Central Florida Expressway Authority
Bridge Ratings Summary
by Florida Department of Transportation
District 5

Bridge Number	Facility	Deck Rating	Superstructure Rating	Substructure Rating	Channel Rating	Culvert Rating	Structure Evaluation	Performance Rating
750407	SR-429 NB	7	8	7	N	N	7	2
750408	SR-429 Ramp L	7	8	7	N	N	7	2
750409	SR-429 SB	7	8	7	N	N	7	2
750410	SR-429 NB	7	7	7	N	N	7	2
750411	Ramp A-NB Exit Ram	7	8	7	N	N	7	2
750412	SR-429 SB	8	8	8	N	N	8	1
750413	SR-429 NB	8	7	8	N	N	7	2
750414	SR-429 SB	8	7	7	N	N	7	2
750415	SR-429 NB	7	8	7	N	N	7	2
750416	SR-429 SB	8	8	8	7	N	8	1
750417	SR-429 NB	8	8	8	7	N	8	1
750418	SR-429 SB	8	8	8	N	N	8	1
750419	SR-429 NB	8	8	8	N	N	8	1
750420	SR-429 SB	7	8	8	N	N	8	2
750421	SR-429 NB	8	8	8	N	N	8	1
750422	West Road	8	7	8	N	N	7	2
750423	West Road	8	8	8	N	N	8	1
750424	SR-417 NB	7	7	8	N	N	7	2
750425	SR-417 SB	7	7	8	N	N	7	2
750426	SR-417 SB	7	7	7	7	N	7	2
750427	SR-417 NB	7	7	7	7	N	7	2
750428	SR-417 SB	7	7	8	N	N	7	2
750429	SR-417 NB	7	7	8	N	N	7	2
750430	SR-417 SB	7	8	7	N	N	7	2
750431	SR-417 NB	7	7	7	N	N	7	2
750432	SR-417 Off Ramp	7	7	7	N	N	7	2
750433	SR-417 SB	7	7	8	N	N	7	2
750434	SR-417 NB	7	8	8	N	N	8	2
750435	SR-417 SB Off Ramp	7	8	8	N	N	8	2
750436	SR-417 SB	8	7	7	N	N	7	2
750437	SR-417 NB	7	7	7	N	N	7	2
750438	SR-417 SB	7	8	7	N	N	7	2
750439	SR-417 NB	7	8	7	N	N	7	2
750440	SR-417 SB	7	7	6	N	N	6	2
750441	SR-417 NB	7	7	7	N	N	7	2
750442	SR-417 SB	7	7	7	N	N	7	2
750443	SR-417 NB	7	7	7	N	N	7	2
750444	SR-417 NB Off Ramp	8	7	7	N	N	7	2
750445	SR-417 SB	7	7	7	N	N	7	2
750446	SR-417 NB	7	7	7	N	N	7	2
750447	SR-417 SB	7	7	7	N	N	7	2
750448	SR-417 NB	7	7	8	N	N	7	2
750449	SR-417 SB Ramp	7	8	7	7	N	7	2
750450	SR-417	7	7	7	7	N	7	2
750451	SR-417	7	7	7	7	N	7	2
750452	SR-417 Off Ramp	7	8	7	7	N	7	2
750453	SR-417	7	7	7	N	N	7	2
750454	SR-417	7	7	7	N	N	7	2
750457	SR-417	8	8	7	N	N	7	2
750458	SR-417	8	8	7	N	N	7	2
750459	SR-417 SB	6	7	7	N	N	7	2
750460	SR-417	6	7	7	N	N	7	2
750461	SR-417 NB	8	7	7	N	N	7	2
750462	SR-417 SB	7	7	7	N	N	7	2
750463	SR-417 SB	7	8	7	N	N	7	2
750464	SR-417 NB	8	7	7	N	N	7	2
750465	SR-417	7	7	7	N	N	7	2
750466	SR-417	7	7	7	N	N	7	2
750467	SR-417	7	7	8	N	N	7	2
750468	SR-417	7	7	7	N	N	7	2

Central Florida Expressway Authority
Bridge Ratings Summary
by Florida Department of Transportation
District 5

Bridge Number	Facility	Deck Rating	Superstructure Rating	Substructure Rating	Channel Rating	Culvert Rating	Structure Evaluation	Performance Rating
750469	SR-417 NB Off Ramp	7	8	8	N	N	8	2
750470	SR-417 Ramp C	7	7	7	N	N	6	2
750471	Ramp To SR-528 WB	7	7	7	N	N	7	2
750472	SR-417	7	7	8	N	N	7	2
750473	SR-417	7	7	8	N	N	7	2
750480	SR-417	N	N	N	6	7	7	2
750481	SR-417	N	N	N	7	7	7	2
750492	SR-429 SB	8	8	8	N	N	8	1
750493	SR-429 NB	8	8	8	N	N	8	1
750494	SR-429 SB	8	8	7	N	N	7	2
750495	SR-429 NB	8	8	7	N	N	7	2
750496	SR-429 SB	7	8	7	N	N	7	2
750497	SR-429 NB	8	8	7	N	N	7	2
750502	SR-429 SB	8	8	8	N	N	8	1
750503	SR-429 NB	8	8	8	N	N	8	1
750504	Johns Road	8	8	8	N	N	8	1
750505	SR-429 SB	8	8	8	N	N	8	1
750506	SR-429 NB	8	8	8	N	N	8	1
750507	SR-429 SB	8	8	8	N	N	8	1
750508	SR-429	8	8	8	N	N	8	1
750509	Ramp C	8	8	7	N	N	7	2
750512	Goldenrod Rd.	7	7	7	N	N	7	2
750520	SR-429 SB	8	8	8	N	N	7	1
750521	SR-429 NB	8	8	8	N	N	7	1
750522	SR-429 SB	8	8	8	N	N	8	1
750523	SR-429 NB	8	8	8	N	N	8	1
750524	SR-429 SB	8	8	8	N	N	8	1
750525	SR-429 NB	8	8	8	N	N	8	1
750526	SR-429 SB	8	8	8	N	N	8	1
750527	SR-429 NB	8	8	8	N	N	8	1
750528	SR-429 SB	8	8	8	N	N	8	1
750529	SR-429 NB	8	8	8	N	N	8	1
750530	Malcolm Rd.	8	7	8	N	N	7	2
750531	SR-429 SB	8	8	8	N	N	8	1
750532	SR-429 NB	8	8	8	N	N	8	1
750533	SR-429 SB	8	8	7	N	N	7	2
750534	SR-429 NB	8	8	7	N	N	7	2
750535	SR-429 SB	8	8	8	N	N	8	1
750536	SR-429 NB	8	8	7	N	N	7	2
750537	SR-429 SB	8	8	8	N	N	8	1
750538	SR-429 NB	8	8	8	N	N	8	1
750539	SR-429 SB	8	7	8	N	N	7	2
750540	SR-429 NB	8	7	8	N	N	7	2
750541	SR-429 SB	8	8	8	N	N	8	1
750542	SR-429 NB	8	8	8	N	N	8	1
750543	SR-429 SB	8	7	7	N	N	7	2
750544	SR-429 NB	8	8	8	N	N	8	1
750547	SR-429 SB	8	8	8	N	N	8	1
750548	SR-429 NB	8	8	8	N	N	8	1
750549	SR-429 SB	8	8	8	N	N	8	1
750550	SR-429 NB	8	8	8	N	N	8	1
750553	SR-429 SB	7	7	8	8	N	7	2
750554	SR-429 NB	7	8	7	6	N	7	2
750557	NB C-D Road Ramp	8	7	7	N	N	5	2
750567	New Independence Pkwy	8	7	8	N	N	7	2
750569	SR-408 EB Ramp C	7	7	8	N	N	7	2
750570	SR-408WB to I-4EB	7	8	8	N	N	8	2
750571	SR-408WB to I-4EB	7	8	8	N	N	8	2
750576	SR-417 NB Ramp B1	8	8	8	N	N	8	1
750579	Lake Underhill Dr.	8	8	8	N	N	8	1

Central Florida Expressway Authority
Bridge Ratings Summary
by Florida Department of Transportation
District 5

Bridge Number	Facility	Deck Rating	Superstructure Rating	Substructure Rating	Channel Rating	Culvert Rating	Structure Evaluation	Performance Rating
750580	SR-408 EB	8	8	8	N	N	8	1
750581	SR-408	8	8	8	N	N	8	1
750589	Conway Rd Ramp	8	8	8	N	N	8	1
750701	SR-408 WB	7	8	8	N	N	8	2
750703	SR-414	8	8	8	N	N	8	1
750704	SR-414	8	8	8	N	N	8	1
750705	SR-414	8	8	8	N	N	8	1
750706	SR-414	8	8	8	N	N	8	1
750707	SR-414	8	7	8	8	N	7	2
750708	SR-414	8	8	8	N	N	8	1
750709	SR-414	8	8	8	N	N	8	1
750710	WB On-Ramp H – A	8	8	8	N	N	8	1
750711	SR-414 EB	8	8	8	N	N	8	1
750712	SR-414	8	8	8	N	N	8	1
750714	SR-429 SB	8	8	8	N	N	8	1
750715	SR-429 NB	8	8	8	N	N	8	1
750716	SR-429 SB	8	8	8	N	N	8	1
750717	SR-429 NB	8	8	8	N	N	8	1
750718	SR-414 Ramp CA	8	9	9	N	N	9	1
750719	SR-429 NB Ramp BF	8	9	9	N	N	9	1
750720	SR-414 WB	8	7	9	N	N	7	2
750721	SR-414 EB	8	8	8	N	N	8	1
750722	SR-429 NB Ramp EG	9	9	9	N	N	9	1
750723	SR-429 NB Ramp	8	8	8	N	N	8	1
750724	Maitland Blvd Ext.	8	8	8	N	N	8	1
750725	Marden Rd	7	7	7	N	N	7	2
750726	SR-414	7	7	7	N	N	7	2
750727	SR-414	8	8	8	N	N	8	1
750728	SR-414 Ramp CA	8	9	9	N	N	9	1
750729	Ramp K	8	8	8	N	N	7	1
750730	Ramp K	7	8	8	N	N	8	2
750731	CR-437 Binion Road	8	8	8	N	N	8	1
750732	SR-429 SB	9	9	9	N	N	9	1
750733	SR-429 NB	9	9	9	N	N	9	1
750734	SR-429 SB	9	9	9	N	N	9	1
750735	SR-429 NB	9	9	9	N	N	9	1
750736	SR-429 Viaduct SB	9	9	9	N	N	9	1
750737	SR-429 NB	9	9	9	N	N	9	1
750738	SR-429 SB	9	9	9	N	N	9	1
750739	SR-429 NB	9	9	9	N	N	9	1
750741	SR-408 WB On-Ramp	9	9	9	N	N	9	1
750742	SR-408 EB Off-Ramp	9	9	9	N	N	9	1
750743	SR-414	8	8	8	N	N	8	1
750805	South Access Rd.	8	8	8	N	N	8	1
750807	SR 528 WB	8	8	8	N	N	8	1
750808	SR-528 EB	8	8	8	N	N	8	1
750823	Ramp G	8	8	8	8	N	8	1
750824	SR-417 Ramp G	8	7	8	N	N	7	2
750825	Ramp D Flyover	9	9	9	N	N	9	1

Note: The inspection does not include pedestrian bridges at plazas.

2014 Annual Inspection Report



Section 3 Inspection Results

CENTRAL FLORIDA EXPRESSWAY AUTHORITY

3. Inspection Results

3.1 Summary of Findings for Roadways, Buildings and Bridges

For reporting purposes, features rated 3 or below are considered deficient and require maintenance in order to improve the feature and protect the public or the system. For features receiving a rating of 4, maintenance is recommended before they become deficient. Maintenance action requirements are specified in Section 2. It should be noted that between the time of the inspection and the time this report is published, many of these deficiencies have already been corrected as part of the Expressway Authority's Maintenance Program. Furthermore, emergency deficiencies considered critical have already been addressed. Refer to Section 3.2 for additional information. Other deficiencies identified can generally be addressed in a timely manner. Table 2 summarizes the findings for the Expressway Authority's system as a whole.

Table 2: Systemwide Summary of Findings

Feature		Rating ⁽¹⁾	Description ⁽²⁾	Most Common Deficient Features ⁽³⁾
Roadways	Roadway / Pavement	7.9	Good	Pavement Void
	Roadside	7.6	Good	Soil Shoulder
	Traffic Services	7.9	Good	Sign & Highway Lights
	Drainage	7.8	Good	Storm Drain
	Vegetation / Aesthetics	7.7	Good	Litter Removal
Buildings		7.6	Good	Receptacles
Bridges		1.7	Good	See note 4

Notes:

1. The rating is the average rating of all inspected features for each category.
2. The description is based on the average rating rounded to the nearest whole value.
3. For Roadways and Buildings, features that are considered deficient are those rated 3 or below.
4. Deficiencies identified on the reports are being addressed by the Expressway Authority. As reported for the Florida Transportation Commission (FTC) performance measures, 99.3% of the bridges on the Expressway Authority's system are rated excellent (1) or good (2). No load or weight restrictions have been imposed that would constrain the use of any bridge on the Expressway Authority's system.

A summary of findings of the physical condition of the roadways, buildings, and bridges for each of the Expressway Authority's system roadways: SR 408 (East-West Expressway), SR 414

(John Land Apopka Expressway), SR 417 (Central Florida GreeneWay), SR 429 (Daniel Webster Western Beltway), SR 451, and SR 528 (Beachline Expressway) is included in the following sections.

Inspection Worksheets for roadways and buildings are included on the compact disk (CD) attached to the back of this report. For security purposes, the latest bridge inspection reports for the bridges along SR 408, SR 414, SR 417, SR 429, SR 451, and SR 528 are not included, but are available for review upon written request to the Expressway Authority.

2014 Annual Inspection Report

East-West Expressway



CENTRAL FLORIDA EXPRESSWAY AUTHORITY

T:\OCEA\BOND INFORMATION\Annual Inspection Reports\INSPECT\2014\graphics\Maps 11/13/14

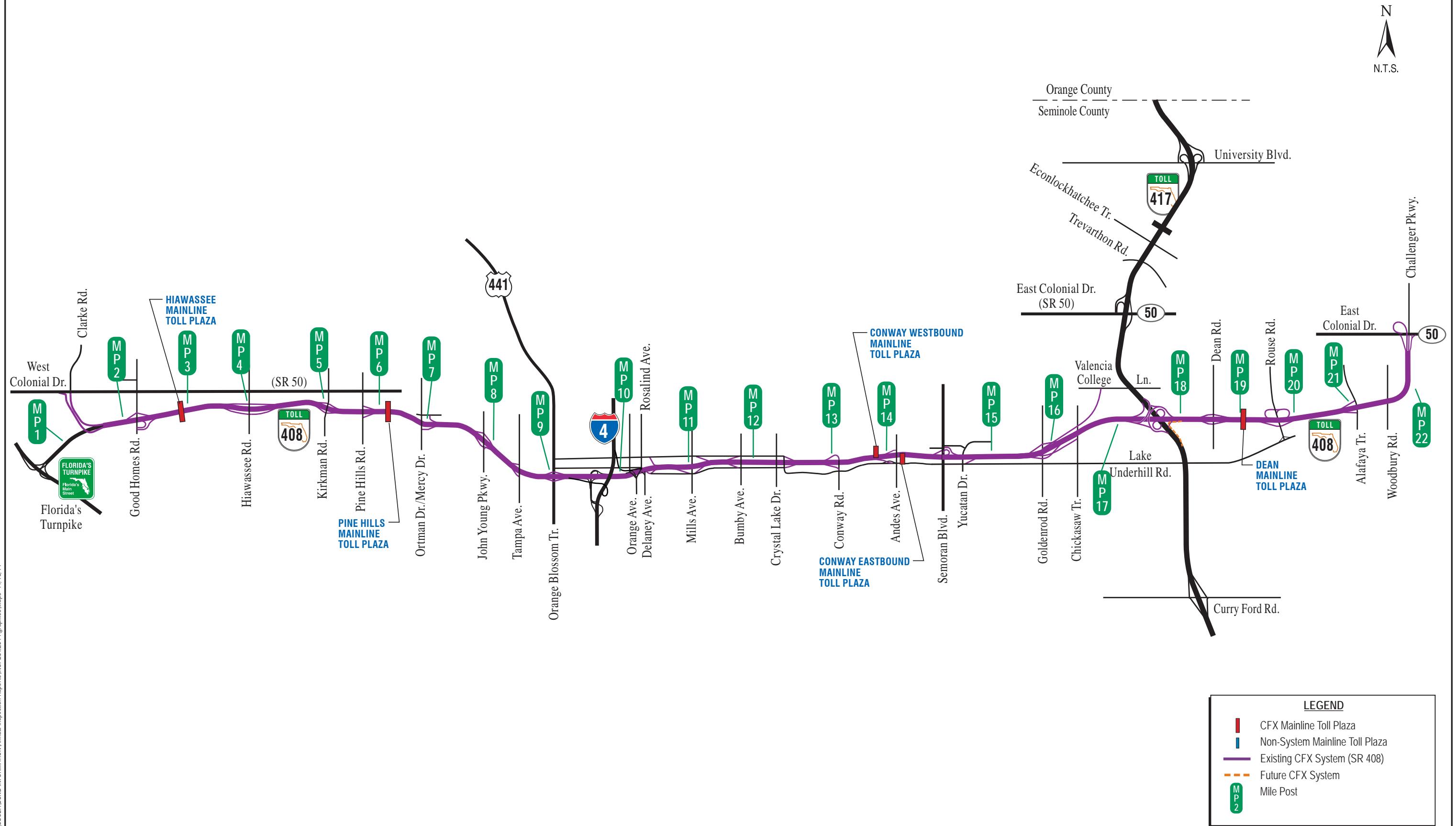

3.1.1 SR 408 (East - West Expressway)

Roadway

The inspection of the roadway and its appurtenances for SR 408 starts near mile post (MP) 1 (at Florida's Turnpike) and extends east past MP 22, which is the beginning of Challenger Parkway. A map showing SR 408 and its mile posts can be found in Figure 3-1.

Specific deficiencies and locations of all SR 408 roadway features are shown in the Roadway Inspection Worksheets on the CD attached to the back of this report.

Roadway/Pavement

Roadway/Pavement features for SR 408 are in generally good condition with pavement void deficiencies being noted at two isolated locations near MP 11.5 along the westbound mainline and at the Rouse Road westbound on ramp.

Cracking was the most common feature that received a rating of 4. Class III cracking is occurring at isolated locations (both eastbound and westbound) along the SR 408 mainline between Hiawassee Road and Mills Avenue, and at a few ramp locations along SR 408. These sections are identified on the Roadway Inspection Worksheets. All of the locations identified as having pavement cracking deficiencies or where maintenance is recommended were also identified in the Expressway Authority's Pavement Management System Needs Analysis and have been included in the Five Year Work Plan (FY 15-19) for repair as resurfacing projects. If specific locations require attention prior to the programmed projects, they can be addressed with the miscellaneous resurfacing.

Maintenance is also recommended for a few joint, stripping, pavement void, bridge, pavement shoulder and shoving features that received a rating of 4.

Out of a total of 1,306 Roadway/Pavement features that were inspected on SR 408, 44 features were rated 4. Maintenance is suggested for those features to prevent them from becoming deficient. Maintenance is required for the two features that were rated at 3 and identified as being deficient. No Roadway/Pavement features were rated at 1 or 2.

Roadside

Roadside features on SR 408 are in good condition with no major deficiencies identified. Maintenance is recommended for fence, soil shoulder and front slope features that were rated at 4.

Out of a total of 507 Roadside features that were inspected on SR 408, 11 received a rating of 4, and maintenance is suggested in order to protect them. No Roadside features received a rating lower than 4, thus equating to no reported Roadside deficiencies.

Traffic Services

Traffic Services features on SR 408 are in good condition, identifying a sign light deficiencies at an isolated location at the SR 408/SR 417 ramps and one information sign deficiency at MP 5 on westbound SR 408 where the view of the sign is obstructed.

Maintenance is recommended for some additional information signs, object markers, pavement symbols, guardrail and pavement markers that were rated at 4.

Out of a total of 1,378 Traffic Services features inspected on SR 408, 18 received a rating of 4. Only two features were considered deficient and rated at 3. No Traffic Services features received a rating lower than 3.

Highway lighting was inspected at night as is in good condition with no deficiencies noted.

Drainage

Drainage features on SR 408 are in good condition with no deficiencies identified.

The most common features that were rated as 4 involve storm drains where the shoulder gutter is cracked or has vegetation growing through it. Maintenance is also proposed for the following features: roadside ditches, inlets, and cross drains.

Maintenance is suggested for the 17 out of the 963 inspected Drainage features on SR 408 that were rated as 4. No Drainage features received a rating lower than 4.

Vegetation/Aesthetics

Vegetation/Aesthetics features along SR 408 (see Picture 1) are in generally good condition with no deficiencies identified.

Tree trimming is proposed at various locations throughout SR 408 to prevent tree limbs from encroaching into travel lanes, fences and other areas. Roadway mowing is recommended where vegetation height needs to be controlled. Maintenance is also suggested for some litter removal, roadway sweep and landscape features that were rated as 4.

Out of the total 828 Vegetation/Aesthetics features that were inspected on SR 408, maintenance is proposed for the 36 that received a rating of 4. No Vegetation/Aesthetic features received a rating lower than 4.



**Picture 1 –
SR 408 Aesthetics**

Buildings

Buildings along SR 408 are generally in good condition.

The most common deficiencies at the SR 408 mainline toll plazas were related to non-working interior and exterior lighting and wiring. Four ratings of 1 were identified. Three of those were located at the Pine Hills mainline toll plaza and related to ceilings, doors/frames and panelboards. The other rating of 1 was at the Dean Road mainline toll plaza and was related to panelboards.

The most common deficiencies at the ramp toll plazas on SR 408 were related to GFCI receptacles not working properly.

Maintenance is recommended for various features throughout the buildings along SR 408, but most commonly for wiring and flooring.



**Picture 2 – CFX
Headquarters Building**

The Expressway Authority's headquarters building, shown in Picture 2, is located along SR 408 near the Conway Westbound Mainline Toll Plaza. The building is in good condition with no deficiencies identified. No features received a rating of 4 or lower.

Individual summaries of building conditions along SR 408 are indicated in the Building Inspection Worksheets included on the CD attached to the back of this report.

Bridges

The latest bridge inspection reports for the bridges along SR 408 are available for review upon request to the Expressway Authority. No significant deficiencies were reported. Minor deficiencies reported are being addressed by the Expressway Authority.

No load limits or weight restrictions have been imposed that would constrain the use of any bridge on SR 408.

2014 Annual Inspection Report

John Land Apopka Expressway



CENTRAL FLORIDA EXPRESSWAY AUTHORITY

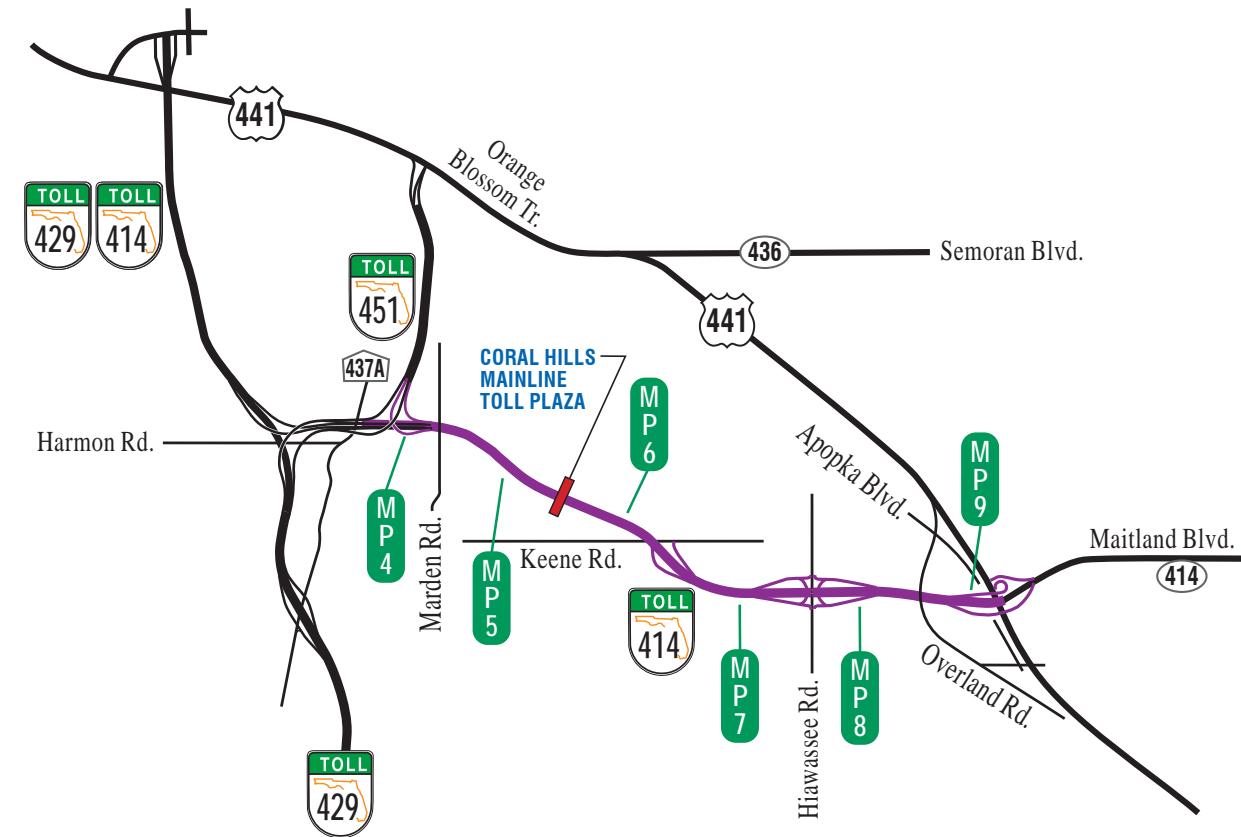

LEGEND

CFX Mainline Toll Plaza

Non-System Mainline Toll Plaza

Existing CFX System (SR 414)

Future CFX System

MP 2

Mile Post

T:\OCEA\BOND INFORMATION\Annual Inspection Reports\INSPECT\2014\graphics\Maps 11/13/14

3.1.2 SR 414 (John Land Apopka Expressway)

Roadway

The inspection of the roadway and its appurtenances for SR 414 starts near MP 3 at SR 429 and extends east past MP 9. A map showing SR 414 and its mile posts can be found in Figure 3-2.

Specific deficiencies and locations of all roadway features along SR 414 are shown in the Roadway Inspection Worksheets included on the CD attached to the back of this report.

Roadway/Pavement

Roadway/Pavement features on SR 414 are in good condition with no deficiencies noted.

Maintenance is recommended at a few isolated locations that received a rating of 4 where joint edges are spalled.

Out of the 289 inspected Roadway/Pavement features on SR 414, only 3 received a rating of 4. Maintenance is suggested in order to prevent those features from becoming deficient. No Roadway/Pavement features received a rating lower than 4, thus no features were considered to be deficient.

Roadside

Roadside features along SR 414 are in good condition. Of the total 120 inspected Roadside features, none were rated deficient, and no additional maintenance is needed. No Roadside features received a rating of 4 or lower.

Traffic Services

Traffic Services features for SR 414 (refer to Picture 3) are in good condition, identifying no deficiencies.

One object marker feature received a rating of 4. It is suggested that the missing milepost sign be installed. Only one feature out of a total of 310 inspected Traffic Services features received a rating of 4. No Traffic Services features were rated lower than 4.

Highway and sign lighting was inspected at night and is in good condition with no deficiencies noted.



Picture 3 – SR 414 Overhead Sign

Drainage

Drainage features on SR 414 are in good condition with no deficiencies.

Out of a total 210 Drainage features that were inspected, none received a rating of 4 or lower.

Vegetation/Aesthetics

Vegetation/Aesthetics features for SR 414 are in generally good condition with no deficiencies.

Out of the total 196 Vegetation/Aesthetics features that were inspected on SR 414, no features received a rating of 4 or lower.

Buildings

Buildings along SR 414 are in good condition with some deficiencies noted at isolated locations.

The most common deficiencies at the Coral Hills Mainline Toll Plaza and at the ramp toll plazas along SR 414 are related to switchboards and breakers.

Maintenance is suggested for a couple of additional issues, mostly at the Coral Hills Mainline toll plaza. No features were rated below a 3.

Individual summaries of building conditions along SR 414 are indicated in the Building Inspection Worksheets on the CD attached to this report.

Bridges

The latest bridge inspection reports for the bridges along SR 414 are available for review upon request to the Expressway Authority. No significant deficiencies were reported. Minor deficiencies reported are being addressed by the Expressway Authority.

No load limits or weight restrictions have been imposed that would constrain the use of any bridge on SR 414.

2014 Annual Inspection Report

Central Florida GreeneWay



CENTRAL FLORIDA EXPRESSWAY AUTHORITY

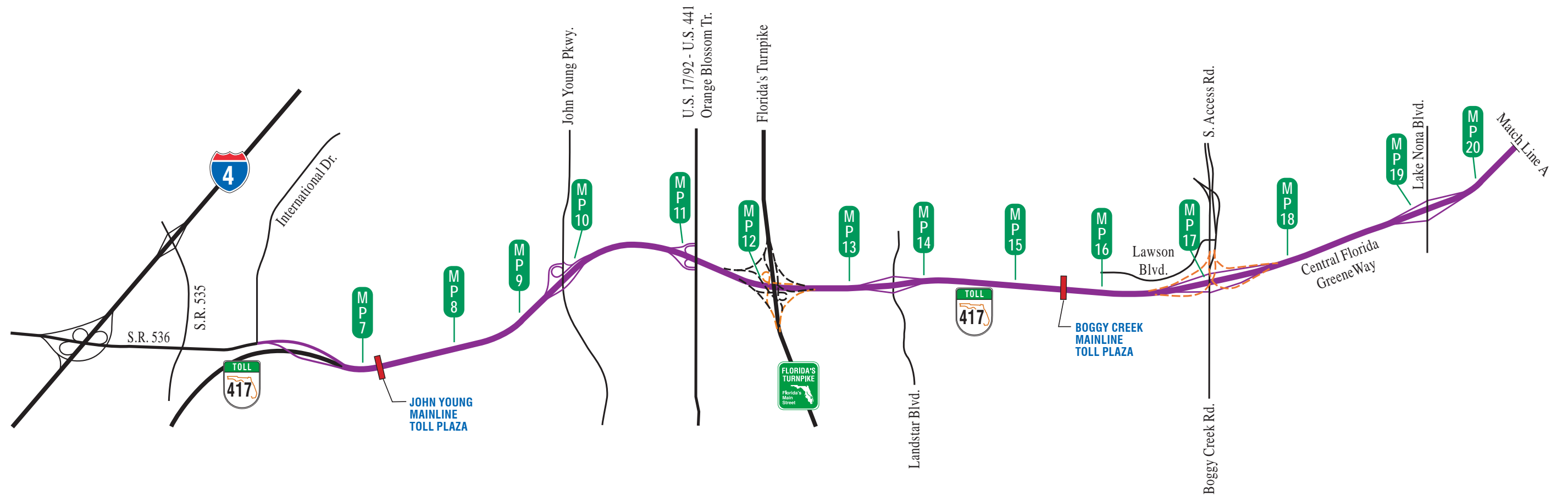

T:\OCEA\BOND INFORMATION\Annual Inspection Reports\INSPECT\2014\graphics\Maps 11/13/14

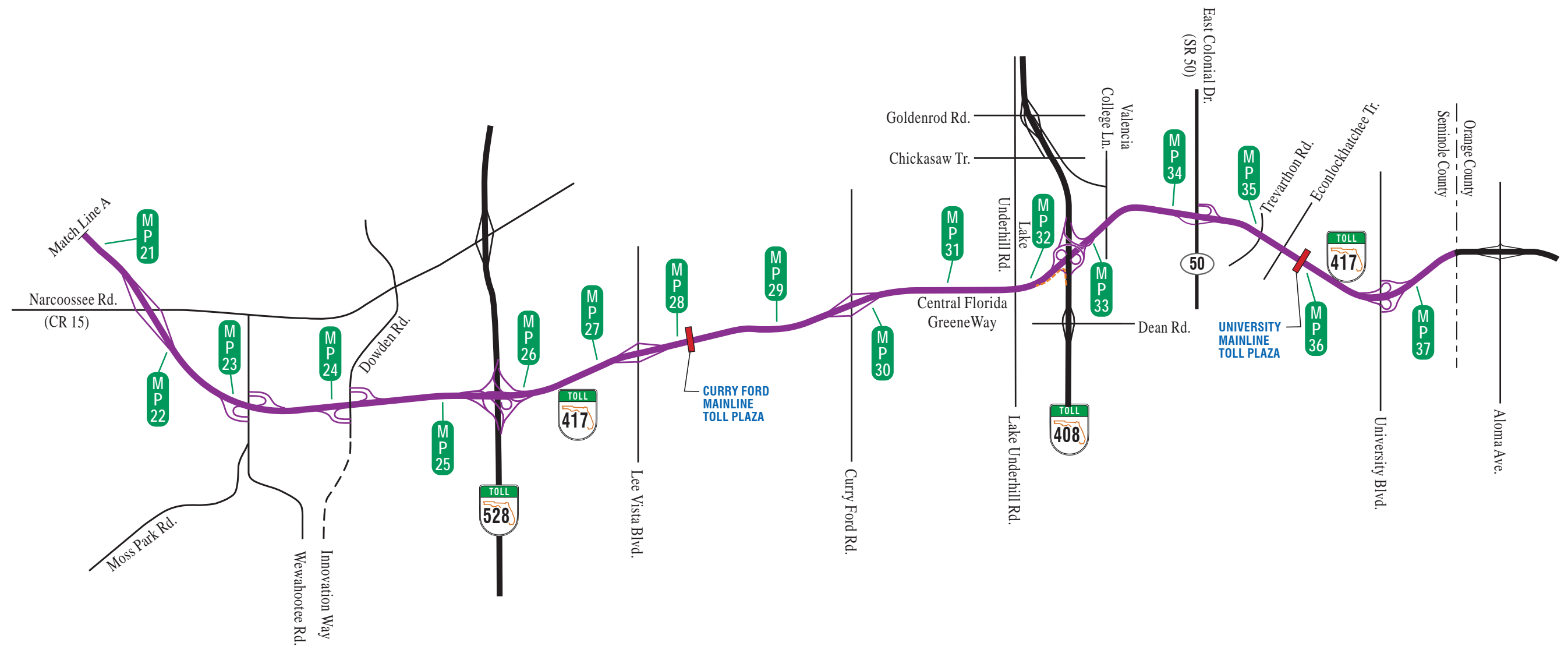

LEGEND

CFX Mainline Toll Plaza

Non-System Mainline Toll Plaza

Existing CFX System (SR 417)

Future CFX System

M P 2

Mile Post

T:\COCEA\BOND INFORMATION\Annual Inspection Reports\INSPECT\2014\graphics\Maps 11/13/14

3.1.3 SR 417 (Central Florida GreeneWay)

Roadway

The inspection of the roadway and its appurtenances for SR 417 starts around MP 6 and extends north past MP 37 to the Orange/Seminole County Line. Figures 3-3 and 3-4 show SR 417 and its mile posts. It should be noted that at the time the 2014 inspection was performed, the following portions of SR 417 were under construction:

- SR 417 / Florida's Turnpike Interchange
- SR 417 / Boggy Creek Road Interchange
- SR 417 Widening from Curry Ford Road to Lake Underhill Road

The portions under construction (from approximately MP 12 to MP 13, MP 15.5 to MP 19, MP 29.5 to MP 31.5 and associated ramps) were not inspected and are shown on the Inspection Worksheets with a rating of 0.

Specific deficiencies and locations of all Roadway features along SR 417 are shown in the Roadway Inspection Worksheets included on the CD attached to the back of this report.

Roadway/Pavement

Roadway/Pavement features for SR 417 are in good condition with only one deficiency noted. A rating of 1 was assigned to a pavement void deficiency at the SR 417 southbound Lee Vista bridge. This deficiency was reported to the Expressway Authority's maintenance staff as a critical item when it was discovered, and maintenance has already repaired it.

Pavement cracking features were the most commonly rated as 4. Most of the Class III cracking was observed on various SR 417 on and off ramps. Locations where pavement cracking was noted during the inspection were also identified in the Expressway Authority's Pavement Management System Needs Analysis and have been included in the Five Year Work Plan (FY 15-19) for repair as resurfacing projects. The Systemwide Friction Course Repair project, currently under construction covers some of the identified areas. The SR 417 Resurfacing from SR 50 to the County line is currently under design, and the SR 417 Resurfacing project from International Drive to Moss Park Road is scheduled to start design in early 2015.

Maintenance is also suggested at various locations along SR 417 for features that were rated as 4 mostly related to stripping, shoving, and joints.

Out of the 1,299 inspected Roadway/Pavement features on SR 417, 56 received a rating of 4, and only one received a rating of 1. Maintenance is recommended for the features rated 4 in order to prevent them from becoming deficient.

Roadside

Roadside features along SR 417 are in fair condition. The most common deficiencies were related to soil shoulder and front slope erosion. The following were rated as 1:

- Soil shoulder erosion where the paved shoulder has been undermined near northbound MP 32
- Soil shoulder adjacent to the paved shoulder where the shoulder gutter and paved shoulder have been undermined near southbound MP 28 (Refer to Picture 4).

These items were reported the Expressway Authority's maintenance staff and addressed prior to this report being published.

At additional locations, features that received a rating of 4 for soil shoulders as well as some front slopes, fences and slope protection, maintenance is suggested to prevent the features from becoming deficient.

Out of the 559 inspected Roadside features on SR 417, 33 received a rating of 4. 10 features were considered deficient, as follows:

- five features received a rating of 3
- three features received a rating of 2
- two features received a rating of 1



Picture 4 – SR 417 Soil Shoulder Erosion

Traffic Services

Traffic Services features on SR 417 are in generally good condition with no deficiencies noted.

Information sign, object marker, striping, warning sign, barrier wall, guardrail, pavement symbol and regulatory sign features received ratings of 4. It is advised that maintenance be performed on these to protect the features and prevent them from becoming deficient.

31 of the 1,381 inspected Traffic Services features on SR 417 received a rating of 4. 15 features were considered deficient and assigned a rating of 3. No Traffic Services features received a rating lower than 3.

Highway and sign lighting was inspected at night and is in good condition. It is suggested that bulbs be replaced at the identified non-working sign and highway lights.

Drainage

Drainage features on SR 417 are in good condition with two reported deficiencies related to roadside ditches and storm drains.

A couple isolated storm drain, roadside ditch, and rip rap features were rated as 4. Maintenance is suggested to inhibit them from becoming deficient.

Out of the 1,049 Drainage features that were inspected on SR 417, only 6 received a rating of 4. No Drainage features received a rating of 3, two features received a rating of 2 and none received a rating of 1.

Vegetation/Aesthetics

Vegetation/Aesthetics features along SR 417 are in good condition with only one litter removal deficiency reported at the SR 417 International Drive southbound off ramp where, as seen on Picture 5, a pile of asphalt was dumped on the paved shoulder. This deficiency received a rating of 1 and was reported to the Expressway Authority as a critical item. The Expressway Authority's maintenance staff has already removed the asphalt from the site.



Picture 5 – Asphalt Pile on SR 417 International Drive SB Off Ramp

Slope mowing and tree trimming is suggested at various areas throughout SR 417. Maintenance is also recommended for the following features which received ratings of 4: litter removal, roadway mowing, roadway sweep and turf condition.

Of the total 879 inspected Vegetation/Aesthetics features on SR 417, 24 received a rating of 4. Maintenance should be performed in order to protect these features.

Buildings

Buildings along SR 417 are in fair condition.

The SR 417 mainline toll plazas experienced deficiencies mostly related to ceilings, lighting and receptacles. In addition, maintenance is suggested at various locations that had features rated as 4.

Four of the five features that received a rating of 1 were located at the John Young Mainline toll plaza and were related to ceiling, and switchboards and breakers. The other rating of 1 was assigned to a non-working emergency light at the Curry Ford Mainline toll plaza.

The most common deficiencies at SR 417 ramp toll plazas were related to non-working GFCI receptacles and non-working switchboards and breakers. Most of the deficiencies were identified at the John Young Parkway, Orange Blossom Trail and Landstar ramps. Four features at the ramp toll plazas on SR 417 received a rating of 1, as summarized below:

- Non-working air conditioners at the Narcoossee and Landstar off ramps
- Wasp nests under the canopy at the US 441 off ramp
- Water intrusion and corrosion of the windows and storefronts at the Curry Ford on ramp plaza

Individual summaries of building conditions along SR 417 are indicated in the Building Inspection Worksheets on the CD included attached to the back of this report.

Bridges

The latest bridge inspection reports for the bridges along SR 417 are available for review upon request to the Expressway Authority. No significant deficiencies were reported. Minor deficiencies reported are being addressed by the Expressway Authority.

No load limits or weight restrictions have been imposed that would constrain the use of any bridge on SR 417.

2014 Annual Inspection Report

Daniel Webster Western Beltway



CENTRAL FLORIDA EXPRESSWAY AUTHORITY

T:\OCEA\BOND INFORMATION\Annual Inspection Reports\INSPECT\2014\graphics\Maps 11/13/14

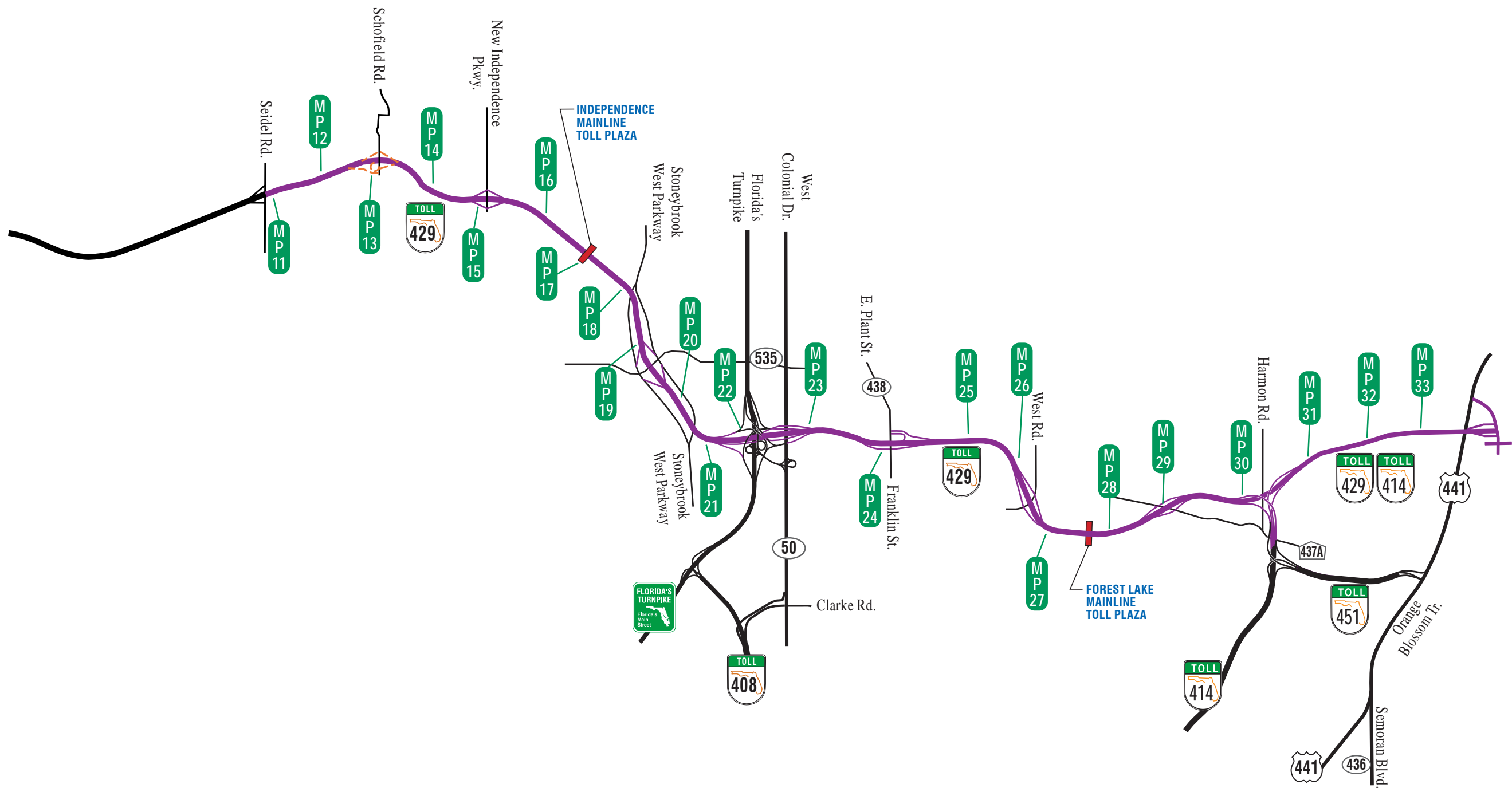

LEGEND

- CFX Mainline Toll Plaza
- Non-System Mainline Toll Plaza
- Existing CFX System (SR 429)
- Future CFX System
- Mile Post

3.1.4 SR 429 (Daniel Webster Western Beltway)

Roadway

The inspection of the roadway and its appurtenances for SR 429 starts at Seidel Road (near MP 11) and extends north past SR 414 and up to US 441 near Plymouth Sorrento Road (past MP 33). The north portion of SR 429, from SR 414 to US 441 was opened to traffic in January 2013, and is known as SR 429/414. A map showing SR 429, the SR 429/414 extension and its mile posts can be found in Figure 3-5.

Specific deficiencies and locations of all roadway features along SR 429 are shown in the Roadway Inspection Worksheets included on the CD attached to the back of this report.

Roadway/Pavement

Roadway/Pavement features on SR 429 are in good condition with one isolated edge ravel deficiency noted at the Forest Lake Mainline.

Maintenance is suggested at a few locations that received ratings of 4 for pavement cracking, joint, stripping and edge ravel features in order to prevent these features from becoming deficient.

12 out of the total 812 inspected Roadway/ Pavement features on SR 429 received a rating of 4. The above mentioned deficiency received a rating of 3. No Roadway/Pavement features on SR 429 received a rating lower than 3.

Roadside

Roadside features along SR 429 are in generally good condition. Only one deficiency was identified at the New Independence Parkway northbound off ramp where a rating of 3 was assigned to a soil shoulder that is exhibiting a 10" drop off adjacent to the paved shoulder.

Maintenance is proposed at some additional locations that exhibit soil shoulder and front slope erosion.

Out of a total of 350 inspected Roadside features on SR 429, 16 received a rating of 4. The features rated 4 should be considered for maintenance in order to prevent them from becoming deficient. No Roadside features on SR 429 received a rating lower than 3.

Traffic Services

Traffic service features on SR 429 are in good condition with no deficiencies.

It is suggested that the various missing object markers be installed. Other ratings of 4 were assigned to information signs and barrier walls. Maintenance is also recommended for those features.

33 of the total 873 inspected Traffic Services features on SR 429 received a rating of 4. It is suggested that maintenance is performed in order to prevent the features from becoming deficient. No Traffic Services features on SR 429 received a rating lower than 4.

Sign and highway lights were inspected at night. At the time the inspection was performed, all the sign and highway lights on SR 429 in the vicinity of the Florida Turnpike and SR 50 interchanges were out. It has since been learned that the conductors in this area were stolen. The issue has since been resolved.

Drainage

Drainage features on SR 429 are in good condition with only one identified deficiency. The rating of 3 was assigned to a storm drain on northbound SR 429 near MP 19.5 where the shoulder gutter is cracked and buckled adjacent to the inlet.

Maintenance is recommended for a few storm drains throughout SR 429 that received ratings of 4 that exhibit cracked and depressed shoulder gutters as well as for an isolated median ditch erosion location.

4 of the 534 inspected Drainage features on SR 429 were rated as 4. Maintenance is recommended to protect those features. Only one feature was rated as 3 and considered deficient. No Drainage features on SR 429 received a rating lower than 3.

Vegetation/Aesthetics

Vegetation/Aesthetics features for SR 429 are in good condition, with no deficiencies.

Roadway and slope mowing, tree trimming, and turf control is suggested at some locations that received a rating of 4.

Out of the total 547 inspected Vegetation/Aesthetic features on SR 429, maintenance should be considered for the 10 features that received a rating of 4. No Vegetation/Aesthetics features received a rating lower than 4.

Buildings

Buildings along SR 429 are generally in good condition. The most common deficiencies for the mainline toll plazas were related to non working or missing emergency lighting and all occurred at the Independence Mainline toll plaza. Maintenance is suggested for

these features rated as 4 at the mainline toll plazas. There were no ratings of 1 at the mainline toll plazas along SR 429.

For the ramp toll plazas along SR 429, the most common deficiencies were related GFCI receptacles. Maintenance is recommended for some features at the CR 535 and the Independence Parkway on ramps. There were no ratings of 1 for the ramp toll plazas.

Individual summaries of building conditions along SR 429 are indicated in the Building Inspection Worksheets on the CD attached to this document.

Bridges

The latest bridge inspection reports for the bridges along SR 429 are available for review upon request to the Expressway Authority. No significant deficiencies were reported. Minor deficiencies reported are being addressed by the Expressway Authority.

No load limits or weight restrictions have been imposed that would constrain the use of any bridge on SR 429.

2014 Annual Inspection Report



CENTRAL FLORIDA EXPRESSWAY AUTHORITY

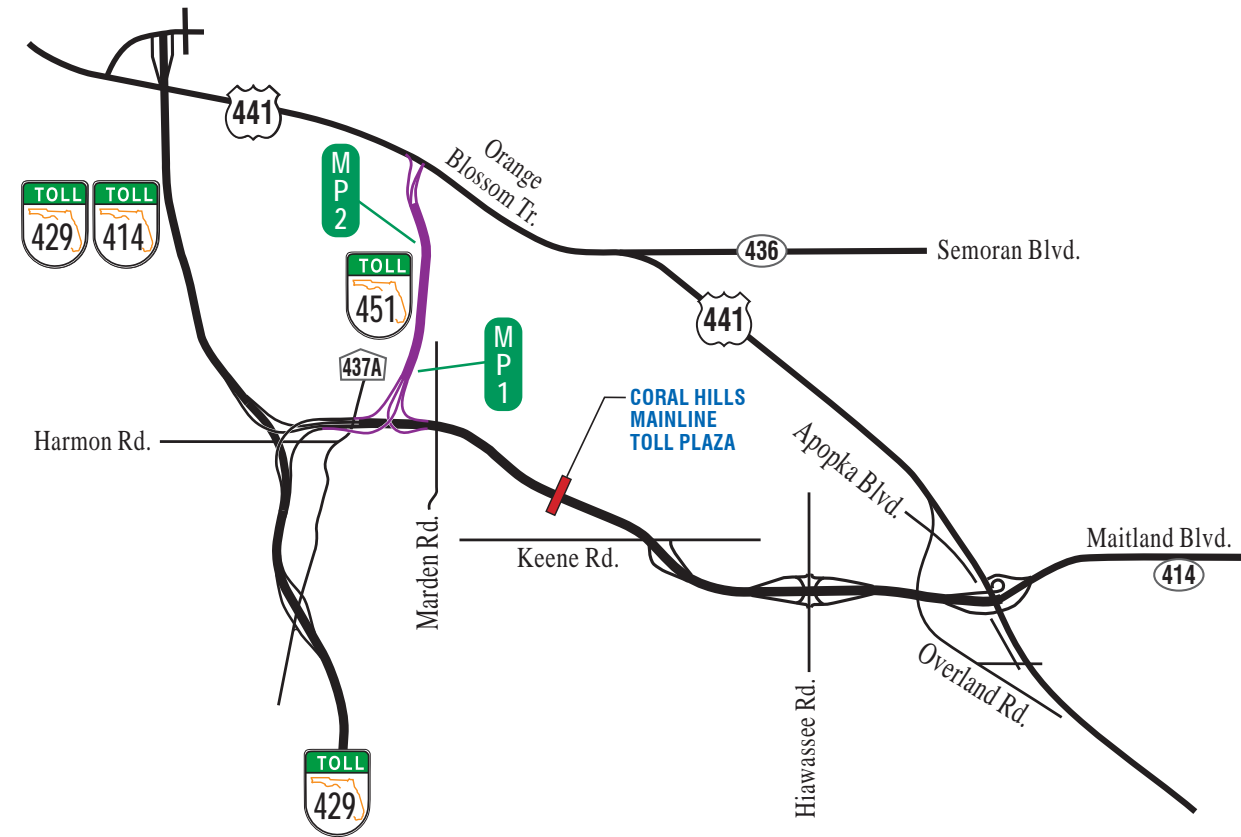

LEGEND

CFX Mainline Toll Plaza

Non-System Mainline Toll Plaza

Existing CFX System (SR 451)

Future CFX System

MP 2

Mile Post

SR 451 MILE POST



FIGURE
3-6

3.1.5 SR 451

Roadway

The inspection of the roadway and its appurtenances for SR 451 starts at SR 414 and extends north to US 441. With the opening of the SR 429/414 expressway in January 2013, this northern portion of the existing SR 429 was re-designated as SR 451. A map showing SR 451 and its mile posts can be found in Figure 3-6.

Specific deficiencies and locations of all roadway features along SR 451 are shown in the Roadway Inspection Worksheets included on the CD attached to the back of this report.

Roadway/Pavement

Roadway/Pavement features on SR 451 are in good condition with no deficiencies. No maintenance requirements were identified.

No Roadway/Pavement features on SR 451 were rated 4 or lower.

Roadside

Roadside features along SR 451 are in good condition with no noted deficiencies. Maintenance is suggested for a soil shoulder at the SR 451 southbound ramp to eastbound SR 414 that exhibits and 8" drop off at the gore area.

No Roadside features on SR 451 were rated lower than 4.

Traffic Services

Traffic Services features on SR 451 are in good condition with no deficiencies noted. No Traffic Services features on SR 451 received a rating of 4 or lower.

Highway and sign lighting was inspected at night and is also in good condition with no deficiencies identified.

Drainage

Drainage features along SR 451 are in good condition with no identified deficiencies. Maintenance is recommended at a storm drain on southbound SR 451 near MP 2 that was rated as 4.

Other than the one feature which was rated as 4, no Drainage features on SR 451 received a rating of lower than 4.

Vegetation/Aesthetics

Vegetation/Aesthetics features on SR 451 are in good condition with no noted deficiencies.

No Vegetation/Aesthetics features received a rating of 4 or less.

Buildings

There are no buildings associated with SR 451.

Bridges

Picture 6 shows the SR 451 northbound bridge over SR 414. The latest bridge inspection reports for the bridges along SR 451 are available for review upon request to the Expressway Authority. No significant deficiencies were reported. Minor deficiencies reported are being addressed by the Expressway Authority.

No load limits or weight restrictions have been imposed that would constrain the use of any bridge on SR 451.



Picture 6 – SR 451 NB bridge over SR 414

2014 Annual Inspection Report

Beachline Expressway



CENTRAL FLORIDA EXPRESSWAY AUTHORITY

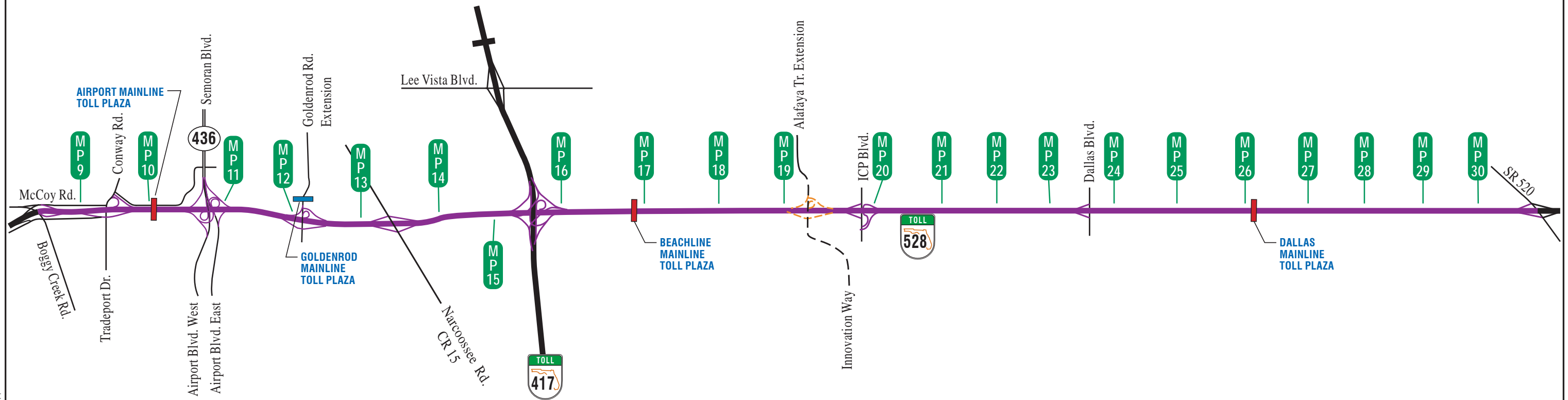

LEGEND

CFX Mainline Toll Plaza

Non-System Mainline Toll Plaza

Existing CFX System (SR 528)

Future CFX System

MP 2

Mile Post

T:\OCEA\BOND INFORMATION\Annual Inspection Reports\INSPECT\2014\graphics\Maps 11/13/14

3.1.6 SR 528 (Beachline Expressway)

Roadway

The inspection of the roadway and its appurtenances for SR 528 starts before MP 9 (near McCoy Road / Boggy Creek Road) and extends east to SR 520. A map showing SR 528 and its mile posts can be found in Figure 3-7.

For SR 528, specific deficiencies and locations of all roadway features are shown in the Roadway Inspection Worksheets included on the CD attached to the back of this report.

Roadway/Pavement

Roadway/Pavement features on SR 528 are in good condition with one deficiency noted. A rating of 1 was given to a joint/spall repair that has re-opened on the eastbound SR 528 near MP 20 at the end of the ICP bridge.

Ratings of 4 were most commonly assigned to pavement cracking. Class III cracking was noticed mainly in the area near the Goldenrod Road interchange. The locations identified for pavement cracking were also identified in the Expressway Authority's Pavement Management System Needs Analysis and have been included in the Five Year Work Plan (FY 15-19) for repair. The Goldenrod Road Milling and Resurfacing project is under contract, and construction will begin in early 2015. The project includes milling and resurfacing of the SR 528 ramps to/from Goldenrod Road and of the SR 528 mainline near the interchange. If other specific locations require attention prior to the programmed projects, they can be addressed with the miscellaneous resurfacings.

Some isolated edge ravel, paved shoulder and shoving features throughout SR 528 were rated as 4. Maintenance is recommended for the 17 out of a total of 805 Roadway/Pavement features inspected on SR 528 that received a rating of 4 in order to prevent them from becoming deficient. Other than the one deficiency mentioned above, no other Roadway/Pavement features received a rating lower than 4.

Roadside

Roadside features along SR 528 are in fair to good condition with two soil shoulder deficiencies identified at the SR 528/SR 436 interchange ramps, both exhibiting erosion adjacent to paved shoulders.

Maintenance is advised for the few additional soil shoulder and front slope features that received a rating of 4, as it will prevent the features from becoming deficient.

For SR 528, 10 of the total 327 inspected Roadside features received a rating of 4. No Roadside features received a rating lower than 3.

Traffic Services

Traffic Service features on SR 528 are in good condition with no identified deficiencies.

Maintenance is proposed for object markers, information signs, guardrail and warning signs that were rated as 4.

12 out of the total 943 inspected Traffic Services features on SR 528 received a rating of 4, and maintenance is suggested to protect the features. No Traffic Services features on SR 528 were rated lower than 4.

Maintenance is suggested for the non-working sign and highway lighting that were identified during the night inspection.

Drainage

Drainage features along SR 528 are in good condition with no noted deficiencies.

The features that were most commonly rated as 4 were roadside ditches, and maintenance for the overgrown vegetation is recommended to protect the features. Maintenance is also recommended at a couple isolated inlets.

Out of a total of 550 inspected Drainage features on SR 528, 9 received a rating of 4. No Drainage features received a rating lower than 4.

Vegetation/Aesthetics

Vegetation/Aesthetics features for SR 528 are in good condition with no documented deficiencies.

Roadway mowing is suggested in some areas to control vegetation height. There is one location that received a rating of 4 where litter removal is suggested.

For SR 528, maintenance is advised for the 6 out of a total of 547 inspected Vegetation/Aesthetics features that were rated at 4. No Vegetation/Aesthetics features received a rating lower than 4.

Buildings

Buildings along SR 528 are generally in good condition. The most common deficiencies for the mainline toll plazas were related to receptacles and switchboards and breakers, were mostly reported at the Beachline Mainline toll plaza. No features at the mainline toll plazas were rated at 1. While most of the maintenance recommendations were made for features at the Airport Mainline toll plaza, the SR 528 Airport Mainline demolition

project is currently under construction, therefore no further action is required at this mainline toll plaza.

The ICP Boulevard and Dallas Boulevard ramp toll plazas experienced a few deficiencies related to switchboards and breakers, ceilings, TVSS, and paint. No ratings of 1 were assigned at the ramp toll plazas. All, but one of the maintenance suggestions for features rated as 4 are at the ICP Boulevard on and off ramps.

Individual summaries of building conditions along SR 528 are indicated in the Building Inspection Worksheets on the CD included attached to this document.

Bridges

The latest bridge inspection reports for the bridges along SR 528 are available for review upon request to the Expressway Authority. Picture 7 shows the completed SR 528 bridge over Daetwyler Drive. The bridge deck replacement project addressed a work order recommendation that was included in last year's bridge inspection reports.



Picture 7 – SR 417 Bridge over Daetwyler Drive

The latest bridge inspection reports identified deficiencies and included work order recommendations for the following bridges:

- Bridge # 750315, SR 436 southbound over Ramp M on SR 528
- Bridge # 750316, SR 436 southbound over SR 528

The SR 528/SR 436 Bridge Deck Replacement project currently in the Five Year Work Plan (FY 15-19) addresses these reported deficiencies. Design is expected to begin in early 2015.

No load limits or weight restrictions have been imposed that would constrain the use of any bridge on SR 528.

3.2 Critical Items Summary

Items that received a rating of 1 during the inspection are considered in need of emergency repair, and require immediate maintenance to protect the public or the system. Critical items rated at 1 were immediately reported to the Expressway Authority's maintenance staff, where the item was routed appropriately and resolved. The following sheets contain the identified critical features, location, condition, and the resolution by the Expressway Authority maintenance staff.

Sample Critical Item Alerts

CENTRAL FLORIDA EXPRESSWAY AUTHORITY

2014 Annual Inspection Critical Roadway Item Alert

Lee Vista Bridge Deck Spall

Roadway: SR 417 SB - MP 27.565
Item Location: Lee Vista Bridge no. 750735
Date Reported: July 30, 2014

Date Repaired: Aug 12, 2014
CFX Contact: Steve Geiss
Inspector: Steve Franklin

Description: 12" X 8" Spall in south approach slab of Lee Vista Bridge no 750735. MP 27.565



Photos 1 & 2 Critical Item Condition - Lee Vista Bridge Deck Spall



Photos 3 & 4 - Spall Repaired – Lee Vista Bridge Deck

CENTRAL FLORIDA EXPRESSWAY AUTHORITY

2014 Annual Inspection Critical Roadway Item Alert

Soil Shoulder Erosion

Roadway: SR 417 Southbound
Item Location: MP 27.689
Date Reported: July 30, 2014

Date Repaired: Aug 12, 2014
CFX Contact: Steve Geiss
Inspector: Steve Franklin

Description: Soil shoulder erosion > 30" adjacent paved shoulder. Shoulder gutter and paved shoulder have been undermined



Photos 1 & 2 Critical Item Condition – Soil Shoulder Erosion



Photos 3 & 4 - Erosion backfilled, compacted, and sod replaced

CENTRAL FLORIDA EXPRESSWAY AUTHORITY

2014 Annual Inspection Critical Roadway Item Alert

Paved Shoulder

Roadway: SR 417 Southbound
Item Location: International Dr. Off Ramp
Date Reported: Aug 7, 2014

Date Repaired: Aug 13, 2014
CFX Contact: Steve Geiss
Inspector: Steve Franklin

Description: 6' x 5' x 2' pile of asphalt has been dumped onto paved shoulder approx 2' from edge of travel lane.



Photo 1 - Critical Item Condition



Photo 2 - Item Repaired - Asphalt Removed

Central Florida Expressway Authority

2014 Annual Inspection Critical Facility Item Alert

Pavement Void

Roadway: SR 417 Southbound
Item Location: John Young Mainline Apron
Date Reported: Sept 16, 2014

Date Repaired: Dec 15, 2014
CFX Contact: Robert Glasemann
Inspector: Steve Franklin

Description: Lane 11 exhibits two significant spalls at joint on south side of SB Canopy. Both spalls extend full depth of slab.



Photos 1 & 2 Critical Item Condition – Pavement Void at Plaza Apron



Photos 3 & 4 – Pavement Void Repaired

Instructions for Viewing CD

1. Insert disk into a computer CD-drive.
2. If CD does not automatically open, go to 'My Computer,' find your CD-drive and click on it to view the contents of the CD.
3. Select any one of the following CFX items:
 - a. 2014 Annual Inspection Report.pdf (Electronic copy of this report)
 - Navigate by going from page to page or use the Bookmarks tab on the left to see specific sections. You may also click on the Table of Contents to navigate to the desired section.
 - b. 2014 Roadway Inspection Worksheets
 - Roadway Inspection Reports are listed by SR, then by Eastbound/Westbound and Northbound/Southbound directions, and by Ramps.
 - The ramps are further organized by alphabetical order.
 - c. 2014 Building_Facilities Inspection Worksheets
 - Building_Facilities Inspection Reports are listed by Roadway, then alphabetically by Plaza Name
 - Ramp Plazas are further broken down by the following:
 - a. Apron
 - b. Canopy
 - c. Combination Building
 - d. Island
 - Mainline Plazas are further broken down by the following:
 - a. Administration Building (further broken down into rooms/areas)
 - b. Apron
 - c. Canopy
 - d. Islands (include Booths)
 - d. Photos
 - Photos are divided into folders that are listed by Roadway and Plaza Name.
 - Photos are then named by location (i.e. Canopy, Apron, Combo Bldg).
 - Extra photos for each location have been placed in a "Misc" folder.



ATKINS

GENERAL CONSULTANT
482 South Keller Road
Orlando, FL 32810
(407) 647-7275
www.atkinsglobal.com/northamerica

**CENTRAL FLORIDA
EXPRESSWAY AUTHORITY**

4974 ORL Tower Road
Orlando, FL 32807
(407) 690-5000
www.expresswayauthority.com